

Fusível Cartucho para Corrente Contínua

DC Ferrul Fuses

gR 440 / 660V DC



Cap.de Ruptura / Breaking capacity = 100 KA

- alta cap. de ruptura / high breaking capacity
- baixa perda / low power dissipation
- limitador de corrente / high current limiting

Dimensões / Dimensions

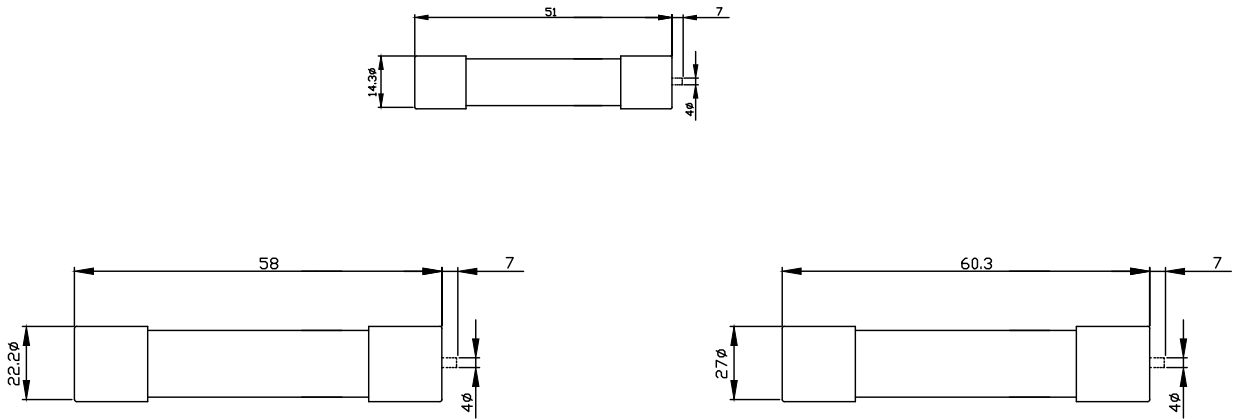

Características Elétricas / Electrical Characteristics

Nr. Ref.	Corrente Current	L / R	Perda Watts	Max. I ² t (A ² s.) Max. I ² t (A ² s.)
5426	2	20 ms.	0.30 W	4
5427	6	20 ms.	0.75 W	12
5428	8	20 ms.	1.10 W	15
5429	10	20 ms.	1.15 W	27
5430	12	20 ms.	1.20 W	38
5431	16	20 ms.	1.25 W	65
5432	20	20 ms.	1.36 W	99
5433	25	20 ms.	1.60 W	150
5434	32	20 ms.	2.40 W	360
5435	40	20 ms.	2.96 W	600
5436	50	20 ms.	3.30 W	1.400
5437	63	20 ms.	3.90 W	1.850
5438	80	20 ms.	5.80 W	3.800
5439	100	20 ms.	7.00 W	8.000
5440	125	20 ms.	12.50 W	12.000
5441	160	20 ms.	13.80 W	15.000

Curva Tempo - Corrente / Melting Time Curve

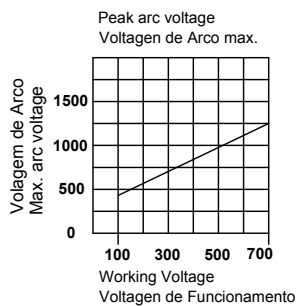
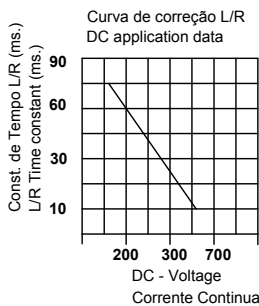
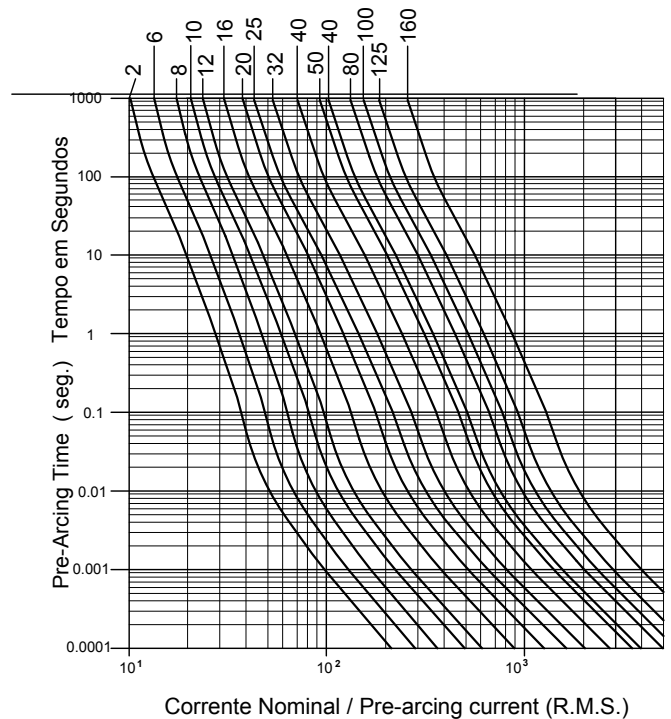

Fusível para Corrente Contínua

DC Square-body Fuses

gR 750V DC



Cap.de Ruptura / Breaking capacity = 100 KA

- alta cap. de ruptura / high breaking capacity
- baixa perda / low power dissipation
- limitador de corrente / high current limiting

Dimensões / Dimensions

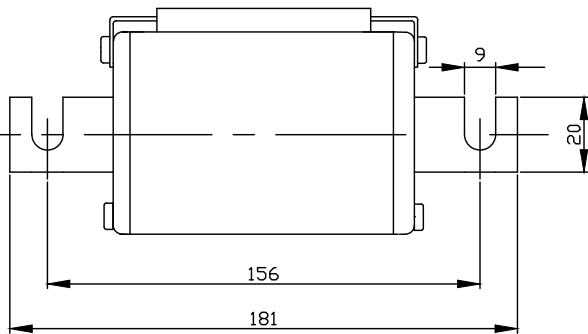

Ligação Parafuso
Flush End Contact

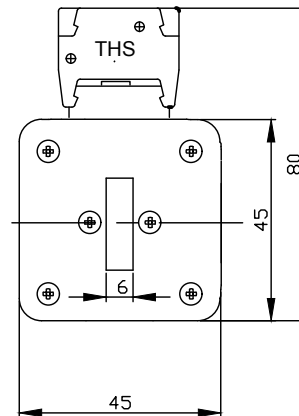
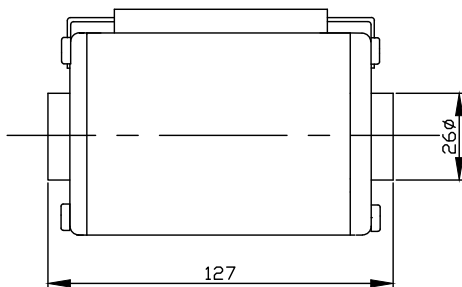

(optional)
Microswitch

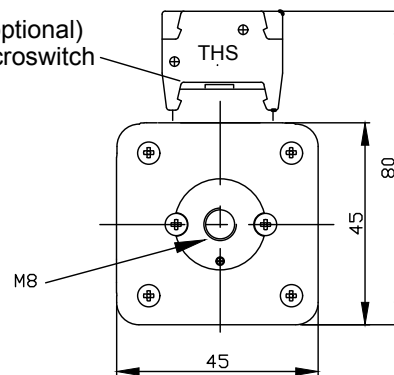

Características Elétricas / Electrical Characteristics

Nr. Ref.	Corrente Current	Tam. Size	L / R	Perda Watts	Max. I ² t (A ² s.)
5377	50	1	100 ms.	5 W	8.000
5378	63	1	100 ms.	6 W	15.000
5379	80	1	100 ms.	8 W	24.500
5380	100	1	100 ms.	9 W	40.000
5381	125	1	100 ms.	11 W	62.500
5382	160	1	100 ms.	15 W	100.000

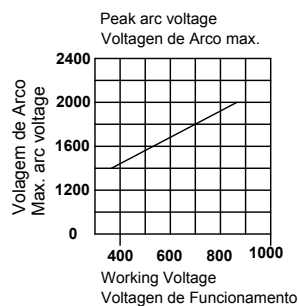
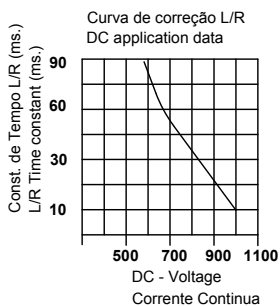

Curva Tempo - Corrente / Melting Time Curve

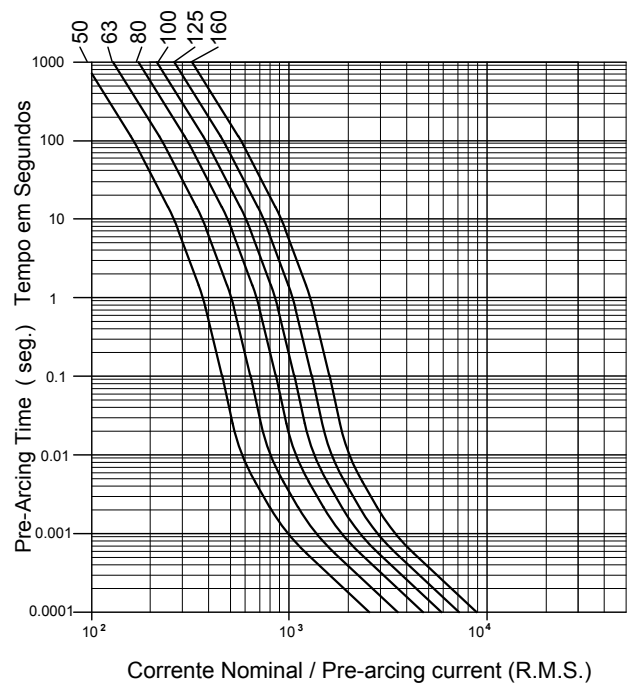

Fusível para Corrente Contínua

DC Square-body Fuses

gR 750V DC



Cap.de Ruptura / Breaking capacity = 100 KA

- alta cap. de ruptura / high breaking capacity
- baixa perda / low power dissipation
- limitador de corrente / high current limiting

Dimensões / Dimensions

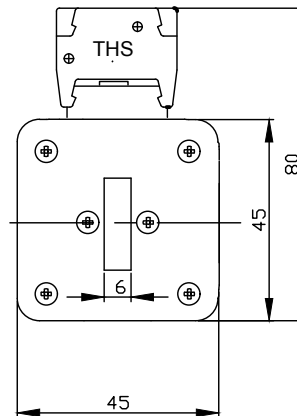
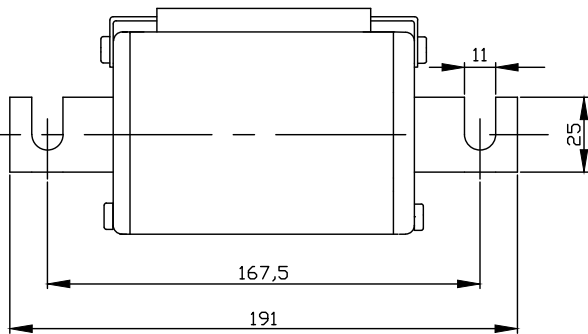

Ligação Parafuso
Flush End Contact

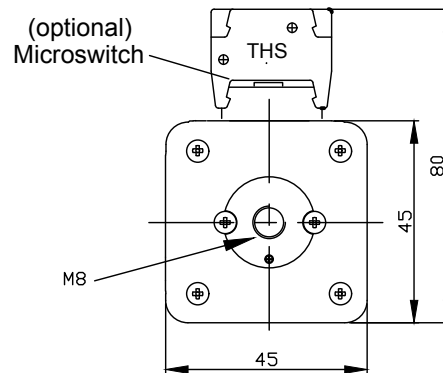
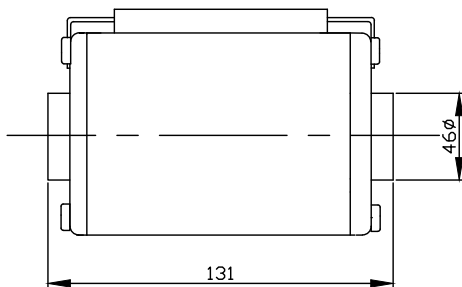

Características Elétricas / Electrical Characteristics

Nr. Ref.	Corrente Current	Tam. Size	L / R	Perda Watts	Max. I ² t (A ² s.) Max. I ² t (A ² s.)
5383	200	1	100 ms.		150.000
5384	250	1	100 ms.		250.000

Curva Tempo - Corrente / Melting Time Curve

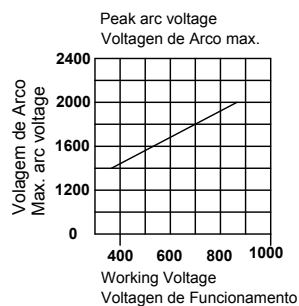
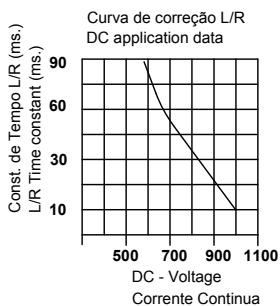
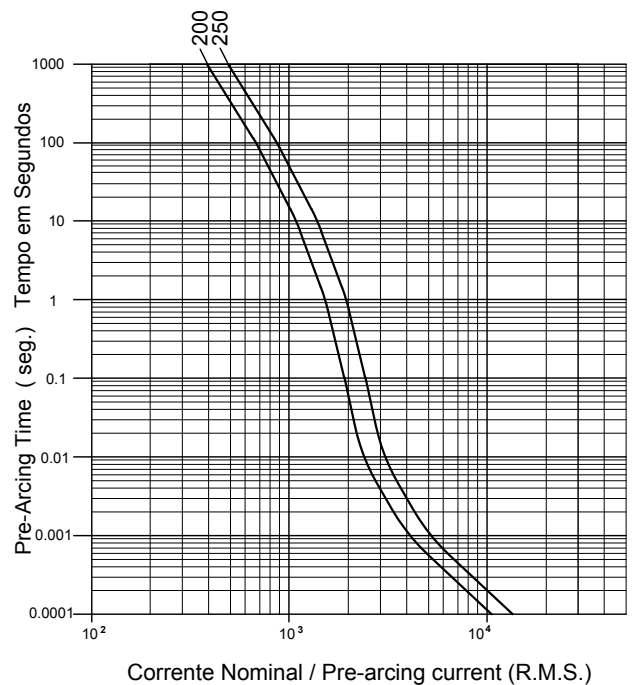

Fusível para Corrente Contínua

DC Square-body Fuses

gR 750V DC



Cap.de Ruptura / Breaking capacity = 100 KA

- alta cap. de ruptura / high breaking capacity
- baixa perda / low power dissipation
- limitador de corrente / high current limiting

Dimensões / Dimensions

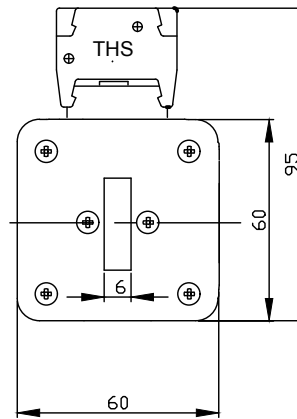
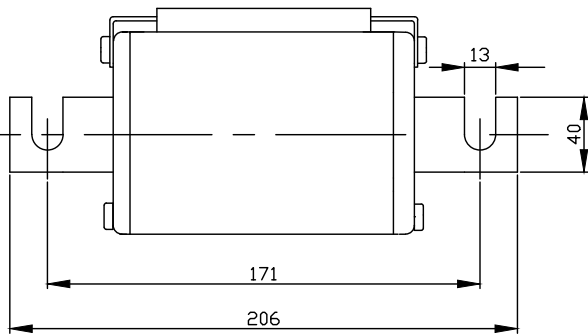

Ligação Parafuso
Flush End Contact

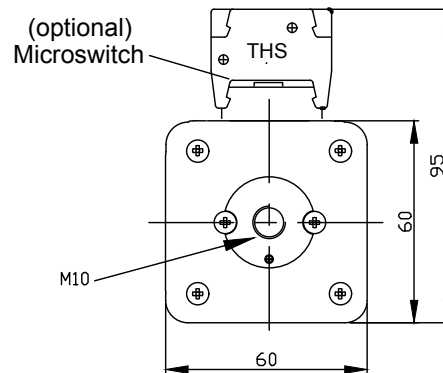
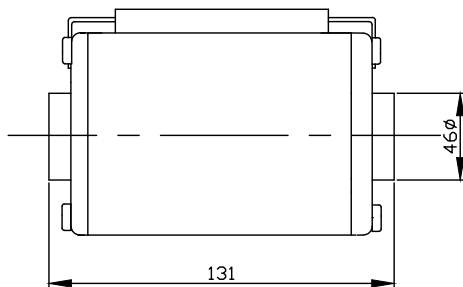

Características Elétricas / Electrical Characteristics

Nr. Ref.	Corrente Current	Tam. Size	L / R	Perda Watts	Max. I ² t (A ² s.)
5385	250	2	100 ms.	26 W	250.000
5386	315	2	100 ms.	32 W	400.000
5387	350	2	100 ms.	35 W	500.000
5388	400	2	100 ms.	41 W	600.000
5389	450	2	100 ms.	51 W	800.000
5390	500	2	100 ms.	54 W	1.200.000

Curva Tempo - Corrente / Melting Time Curve

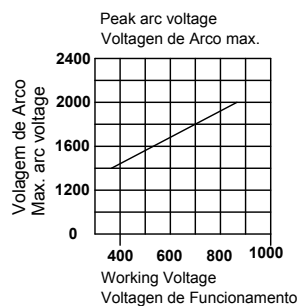
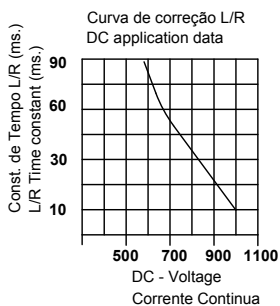
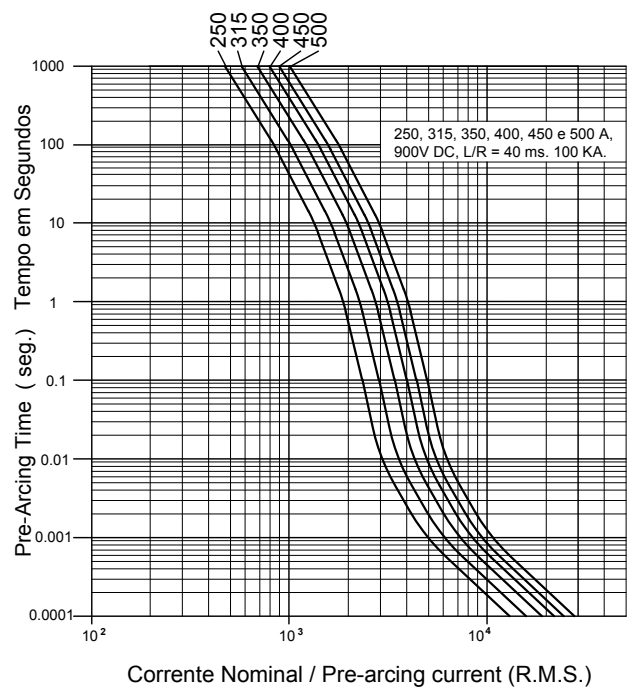

Fusível para Corrente Contínua

DC Square-body Fuses

gR 750V DC



Cap.de Ruptura / Breaking capacity = 100 KA

- alta cap. de ruptura / high breaking capacity
- baixa perda / low power dissipation
- limitador de corrente / high current limiting

Dimensões / Dimensions

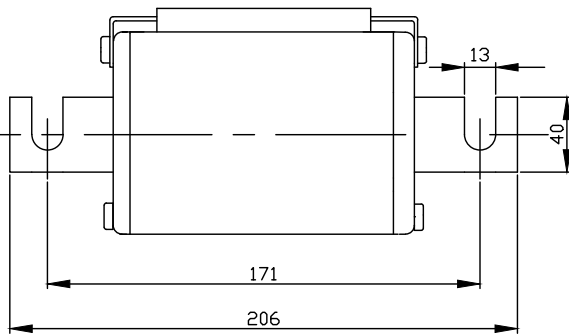

Ligação Parafuso
Flush End Contact

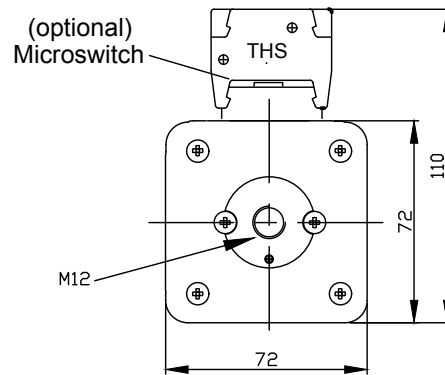
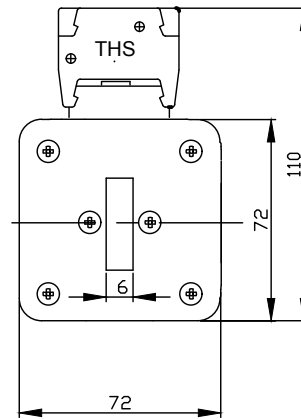
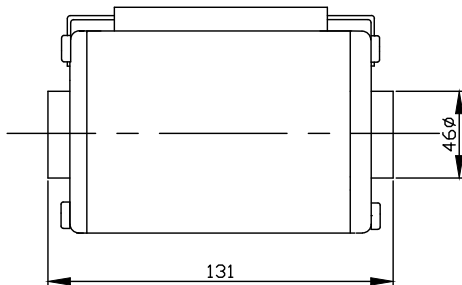

Características Elétricas / Electrical Characteristics

Nr. Ref.	Corrente Current	Tam. Size	L / R	Perda Watts	Max. I ² t (A ² s.)
5391	500	3	100 ms.	55 W	5.000.000
5392	630	3	50 ms.	79 W	7.000.000
5393	700	3	50 ms.	85 W	10.000.000
5394	750	3	50 ms.	85 W	10.000.000
5395	800	3	50 ms.	85 W	12.000.000

Curva Tempo - Corrente / Melting Time Curve

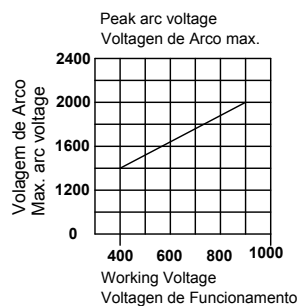
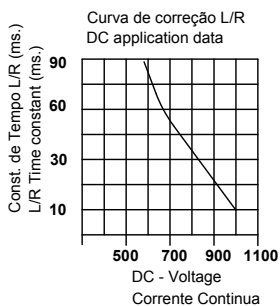
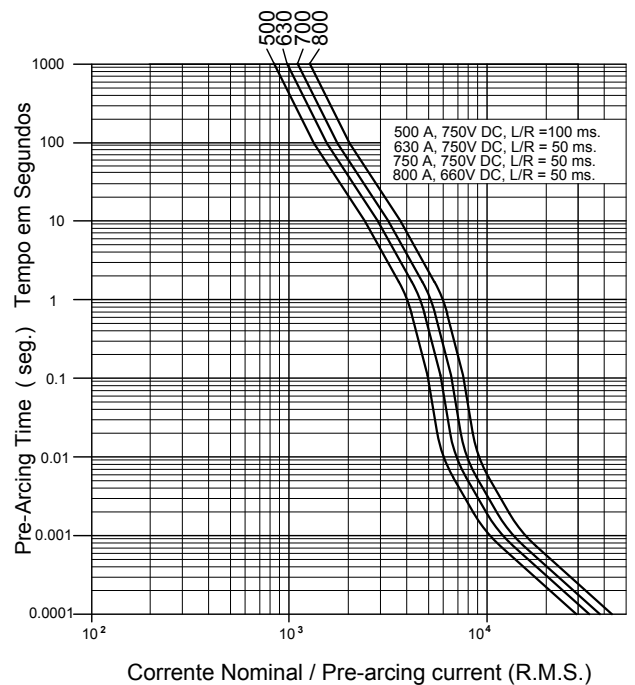

Fusível para Corrente Contínua DC Square-body Fuses gR 750V DC



Cap.de Ruptura / Breaking capacity = 100 KA

Dimensões / Dimensions

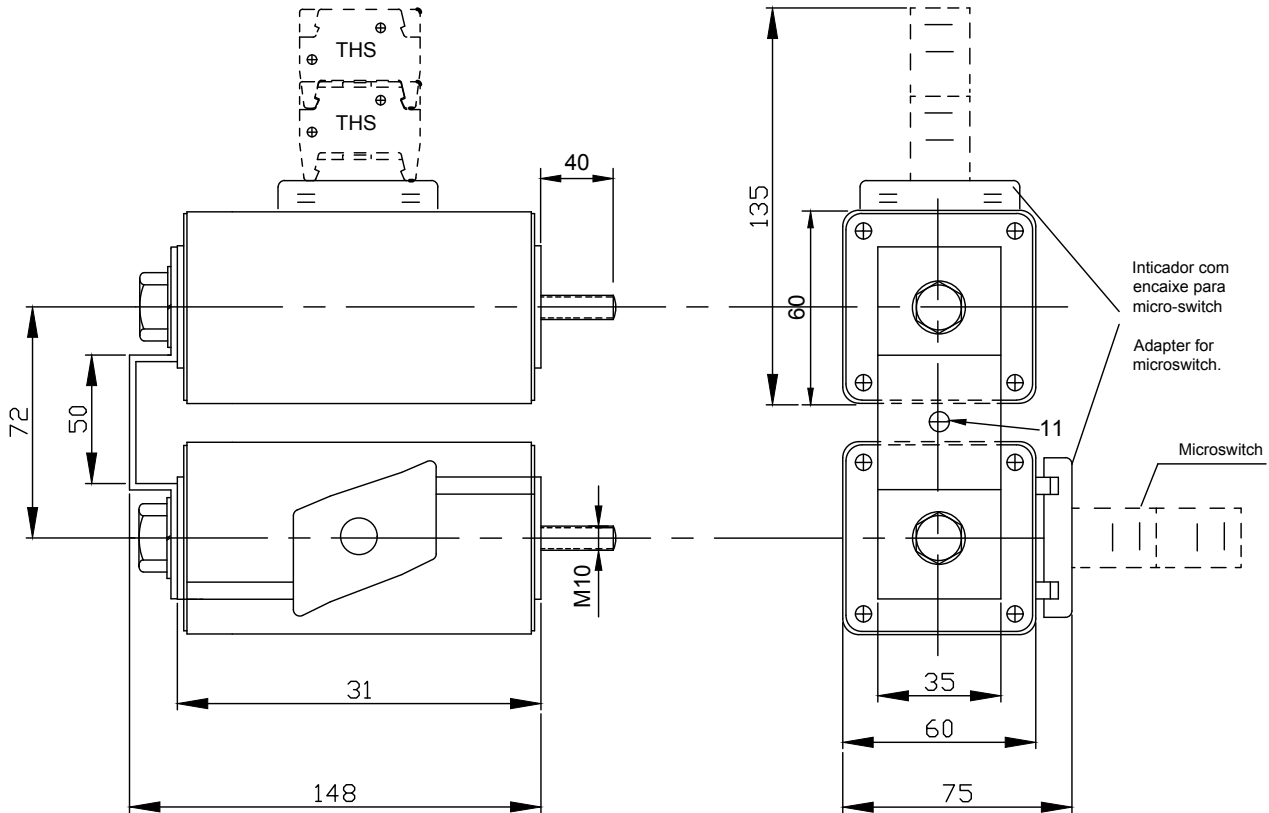

Características Elétricas / Electrical Characteristics

Nr. Ref.	Corrente Current	Tam. Size	L / R	Perda Watts	Max. I ² t (A ² s.)
5396	500	2	40 ms.	51 W	1.100.000
5397	630	2	40 ms.	63 W	1.600.000
5398	800	2	40 ms.	81 W	2.400.000
5399	900	2	40 ms.	99 W	3.200.000
5400	1000	2	40 ms.	108 W	5.000.000

Curva Tempo - Corrente / Melting Time Curve

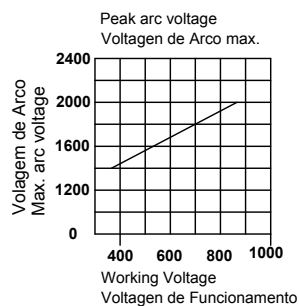
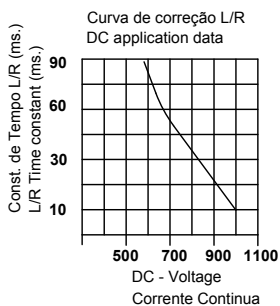
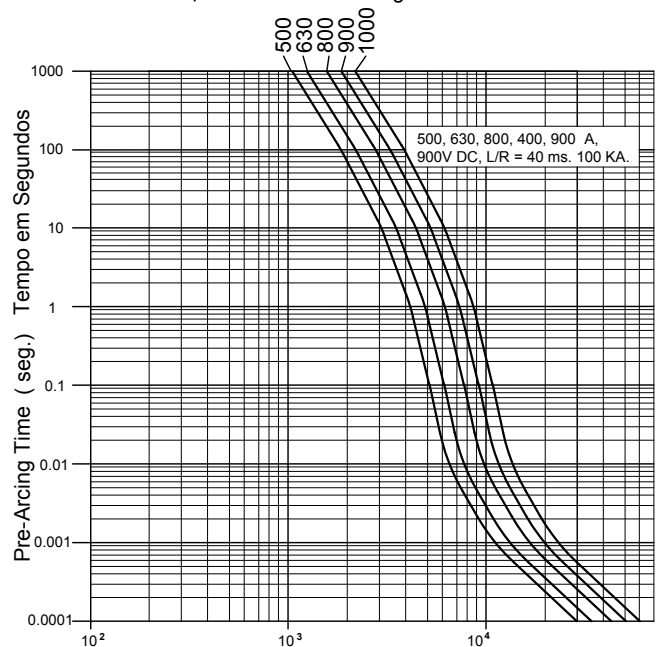

Corrente Nominal / Pre-arcing current (R.M.S.)

Fusível para Corrente Contínua

DC Square-body Fuses

gR 750V DC



Cap.de Ruptura / Breaking capacity = 100 KA

Dimensões / Dimensions

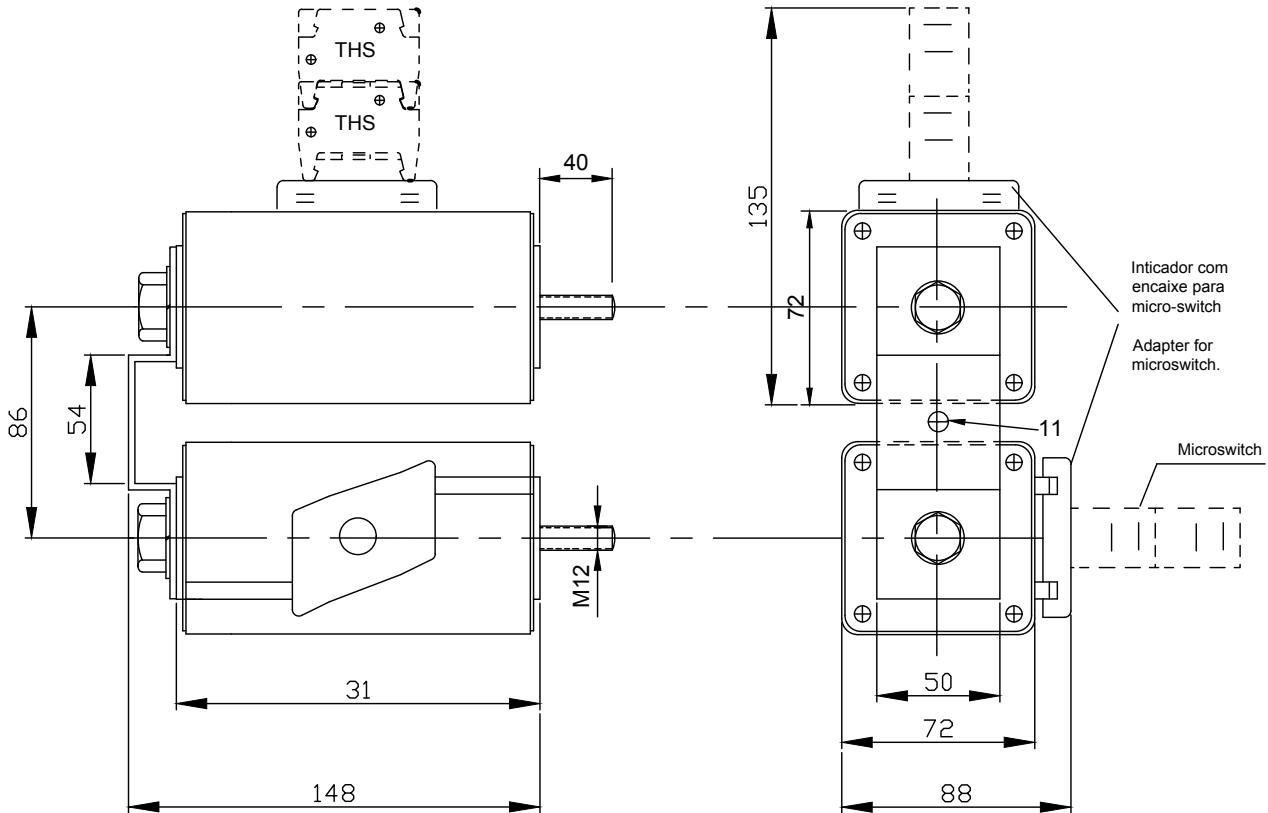

Características Eletricas / Electrical Characteristics

Nr. Ref.	Corrente Current	Tam. Size	L / R	Perda Watts	Max. I ² t (A ² s.)	Max. I ² t (A ² s.)
5401	1000	3	100 ms.	103 W	4.100.000	
5402	1250	3	50 ms.	148 W	6.000.000	
5403	1400	3	50 ms.	165 W	7.400.000	
5404	1500	3	50 ms.	167 W	8.200.000	
5405	1600	3	50 ms.	180 W	9.800.000	

Curva Tempo - Corrente / Melting Time Curve

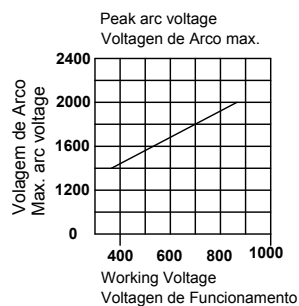
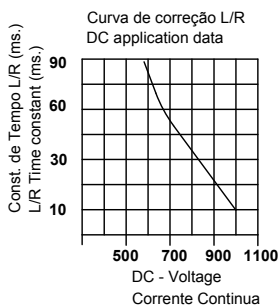
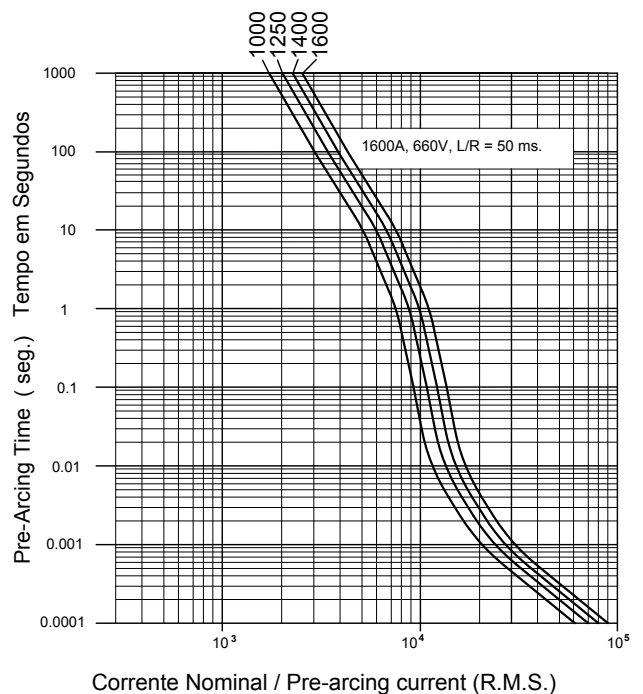

Fusível Cartucho para Corrente Contínua

DC Ferrul Fuses

gR 1000V DC



Cap.de Ruptura / Breaking capacity = 100 KA

- alta cap. de ruptura / high breaking capacity
- baixa perda / low power dissipation
- limitador de corrente / high current limiting

Dimensões / Dimensions

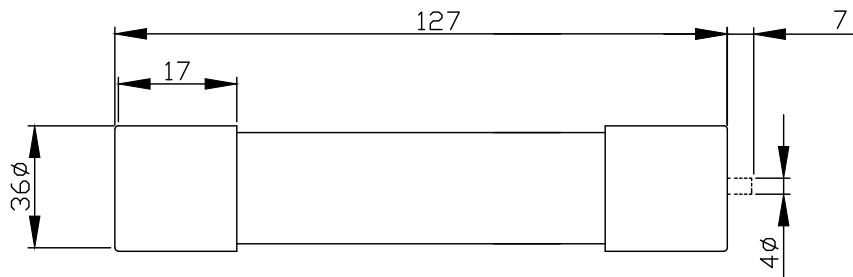

Características Elétricas / Electrical Characteristics

Nr. Ref.	Corrente Current	L / R	Perda Watts	Max. I ² t (A ² s.) Max. I ² t (A ² s.)
5419	25	20 ms.	5.2 W	28
5420	32	20 ms.	6.5 W	72
5421	40	20 ms.	7.1 W	180
5422	50	20 ms.	8.6 W	300
5423	63	20 ms.	10 W	580
5424	80	20 ms.	12 W	1.000
5425	100	20 ms.	13 W	1.500

Curva Tempo - Corrente / Melting Time Curve

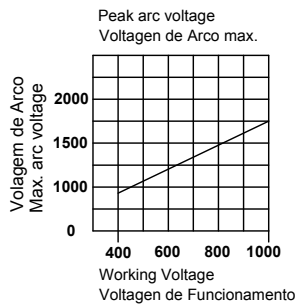
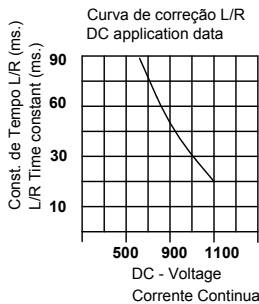
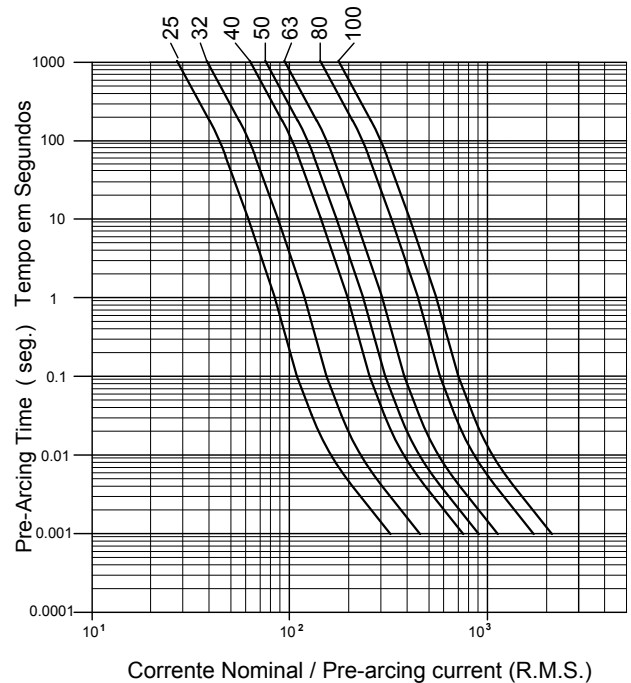

Fusível para Corrente Contínua DC Square-body Fuses gR 1200V DC



Cap.de Ruptura / Breaking capacity = 100 KA

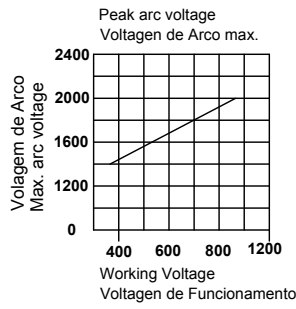
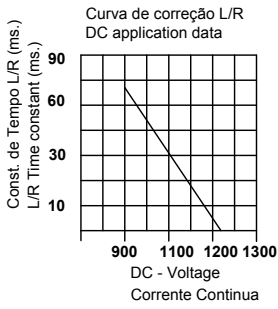

Curva Tempo - Corrente / Melting Time Curve

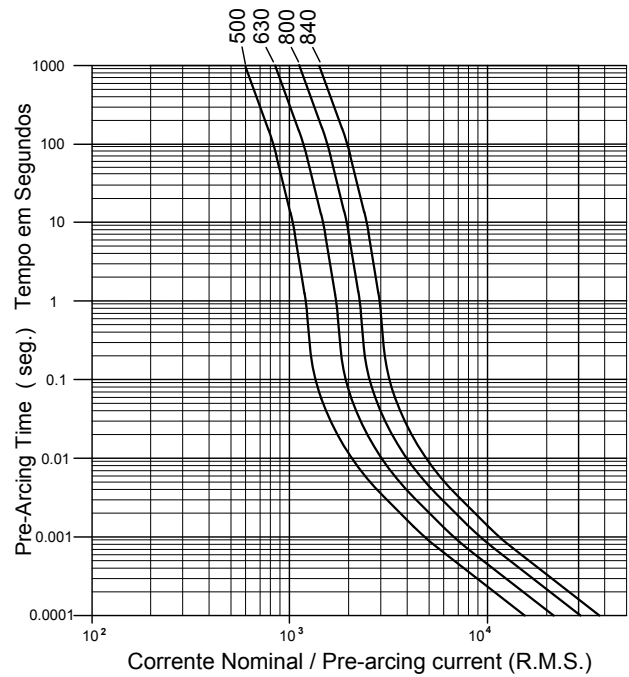

Características Elétricas / Electrical Characteristics

Nr. Ref.	Corrente Current	Tam. Size	L / R	Perda Watts	Max. I²t (A²s.) Max. I²t (A²s.)
5460	500	2x2	15 ms.	120 W	185.000
5461	630	2x2	15 ms.	125 W	360.000
5462	800	2x2	15 ms.	140 W	728.000
5463	840	2x2	15 ms.	145 W	880.000

Dimensões / Dimensions

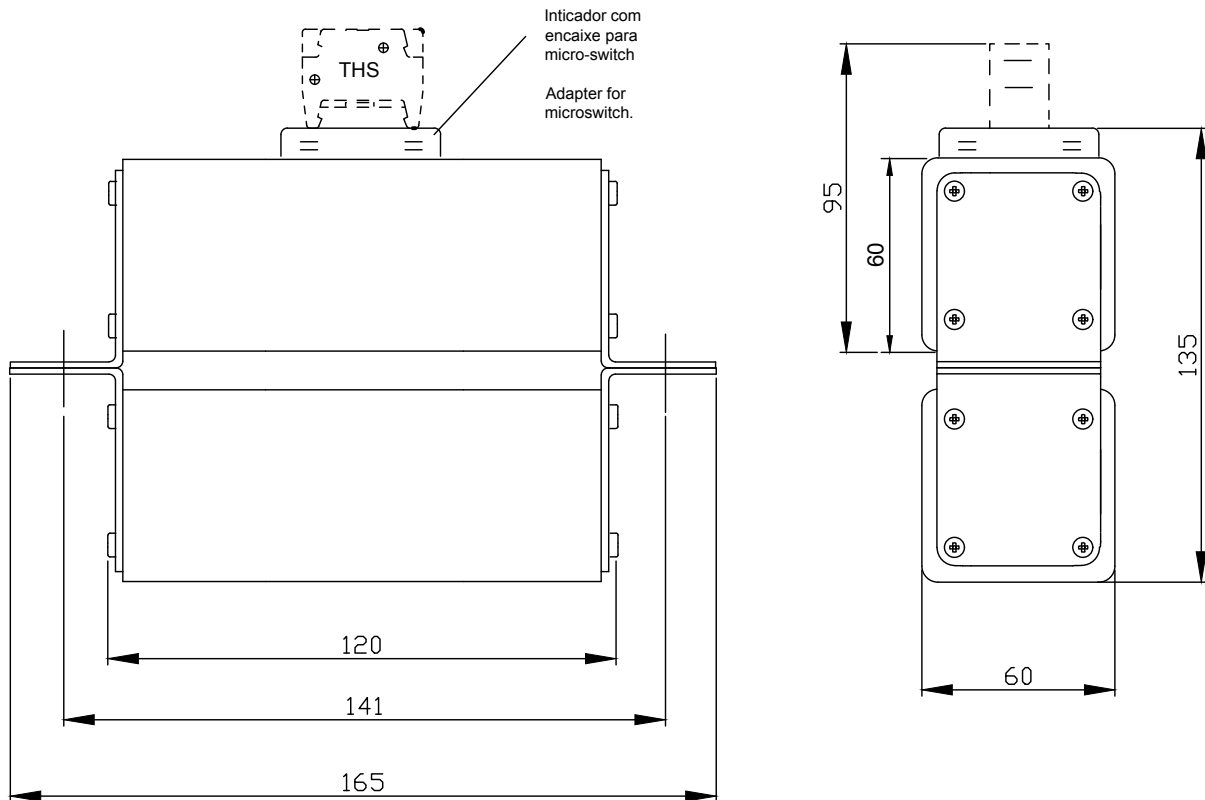

Fusível para Corrente Contínua

DC Square-body Fuses

gR 1200V DC

Cap.de Ruptura / Breaking capacity = 100 KA



Dimensões / Dimensions

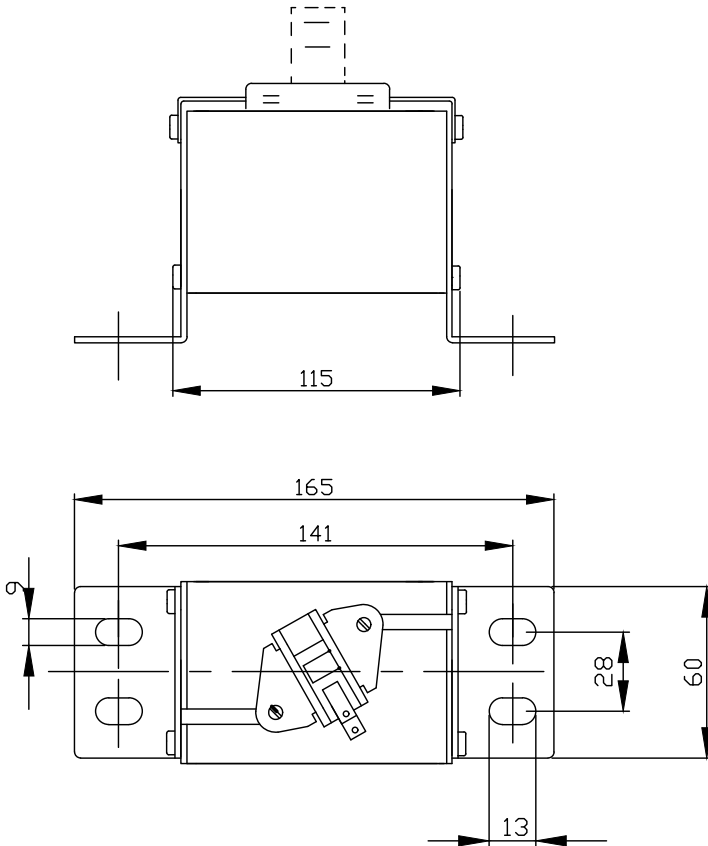

- alta cap. de ruptura / high breaking capacity
- baixa perda / low power dissipation
- limitador de corrente / high current limiting

Características Elétricas / Electrical Characteristics

Nr. Ref.	Corrente Current	Tam. Size	L / R	Perda Watts	Max. I ² t (A ² s.) Max. I ² t (A ² s.)
5454	160	2	15 ms.	40 W	12.000
5455	200	2	15 ms.	50 W	21.000
5456	250	2	15 ms.	58 W	45.000
5457	315	2	15 ms.	62 W	90.000
5458	400	2	15 ms.	67 W	182.000
5459	420	2	15 ms.	70 W	220.000

Curva Tempo - Corrente / Melting Time Curve

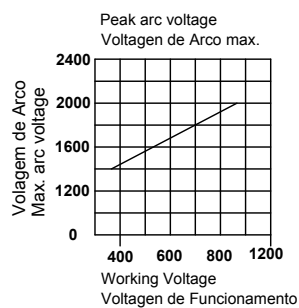
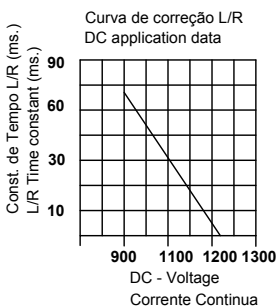
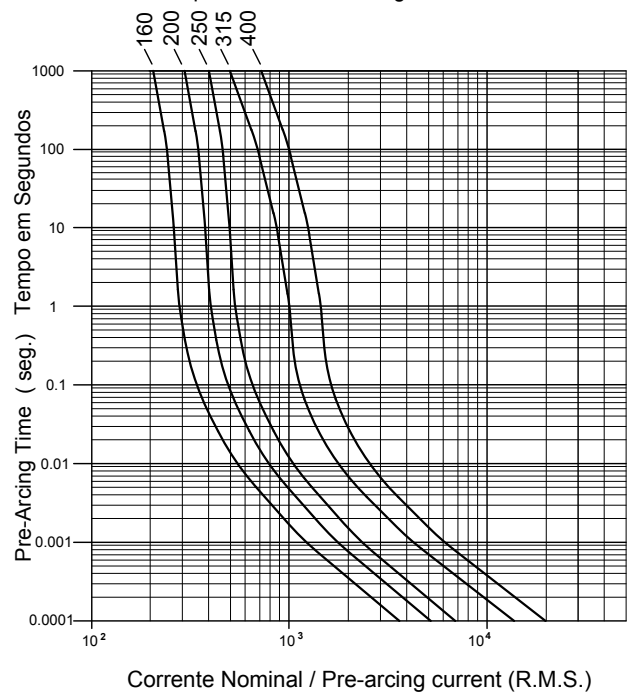

Fusível para Corrente Contínua DC Square-body Fuses gR 1200V DC

Cap.de Ruptura / Breaking capacity = 100 KA



Dimensões / Dimensions

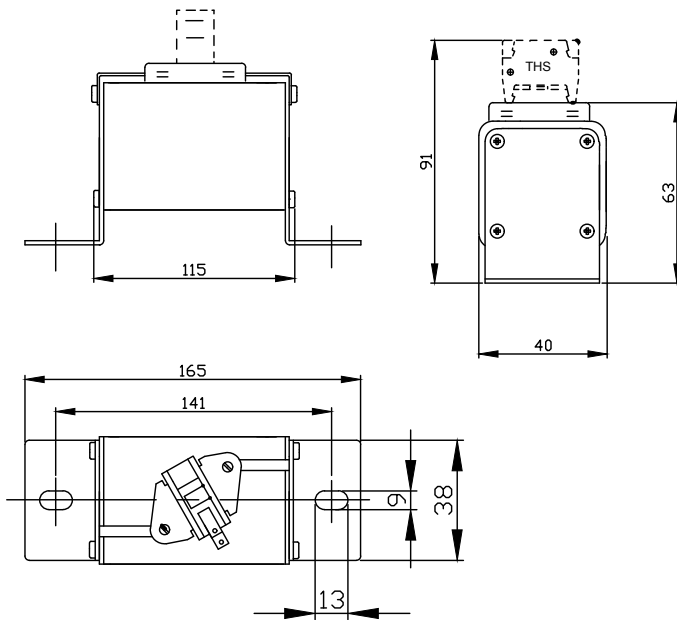

Curva Tempo - Corrente / Melting Time Curve

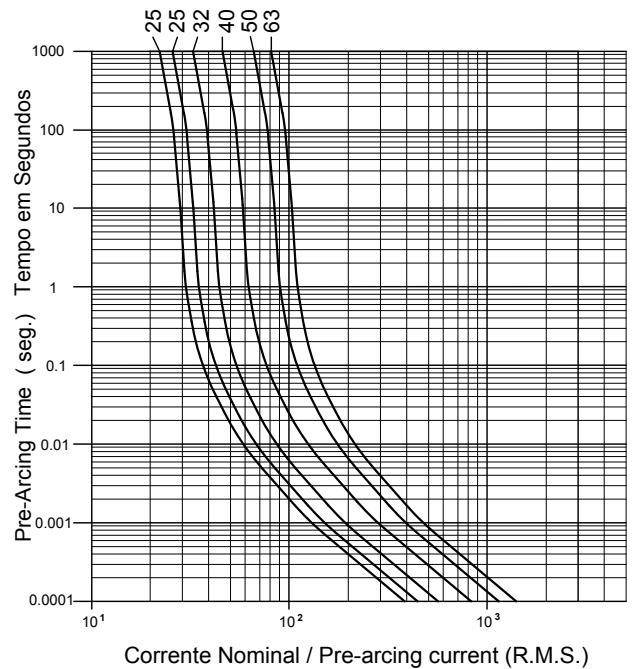

Características Elétricas / Electrical Characteristics

Nr. Ref.	Corrente Current	Tam. Size	L / R	Perda Watts	Max. I ² t (A ² s.)	Max. I ² t (A ² s.)
5442	20	1	15 ms.	5 W	180	
5443	25	1	15 ms.	6 W	250	
5444	32	1	15 ms.	8 W	355	
5445	40	1	15 ms.	9 W	580	
5446	50	1	15 ms.	12 W	1030	
5447	63	1	15 ms.	15 W	1600	
5448	80	1	15 ms.	18 W	3100	
5449	100	1	15 ms.	22 W	5800	
5450	125	1	15 ms.	28 W	9250	
5451	160	1	15 ms.	35 W	19200	
5452	200	1	15 ms.	40 W	45000	
5453	215	1	15 ms.	45 W	55000	

Curva Tempo - Corrente / Melting Time Curve

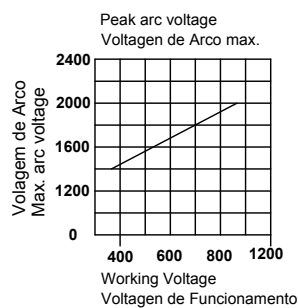
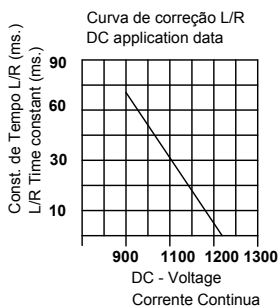
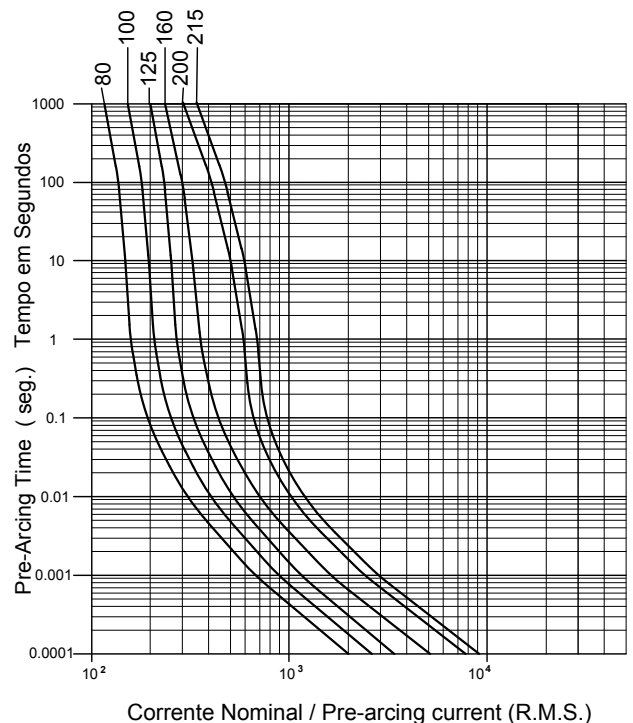

Fusível Cartucho para Corrente Contínua

DC Ferrul Fuses

gR 1500V DC



Cap.de Ruptura / Breaking capacity = 100 KA

- alta cap. de ruptura / high breaking capacity
- baixa perda / low power dissipation
- limitador de corrente / high current limiting

Dimensões / Dimensions

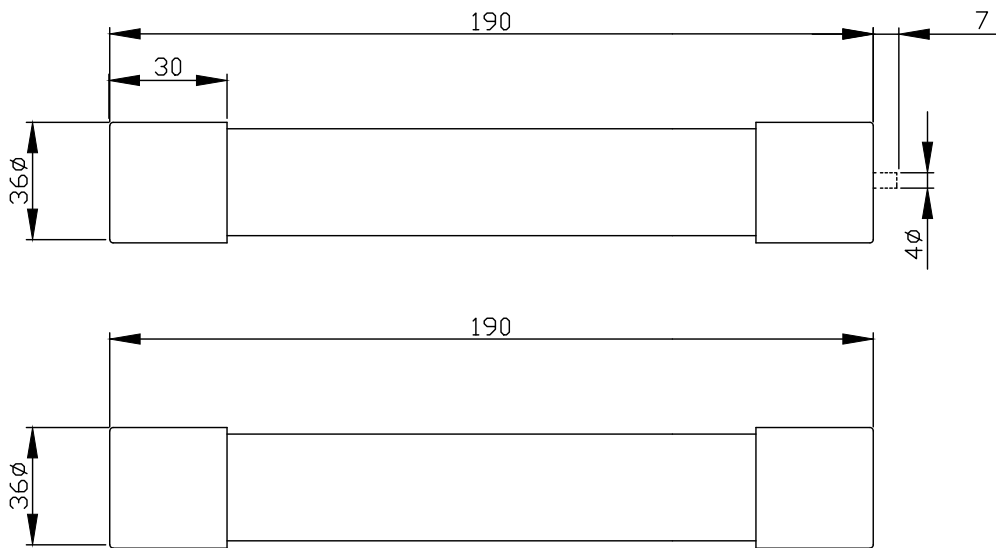

Características Elétricas / Electrical Characteristics

Nr. Ref.	Corrente Current	L / R	Perda Watts	Max. I ² t (A ² s.) Max. I ² t (A ² s.)
5406	40	60 ms.	14 W	450
5407	50	60 ms.	16 W	840
5408	63	60 ms.	20 W	1.470
5409	80	60 ms.	21 W	3.300
5410	100	60 ms.	23 W	6.000

Curva Tempo - Corrente / Melting Time Curve

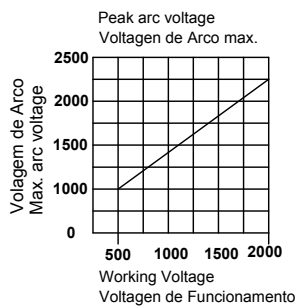
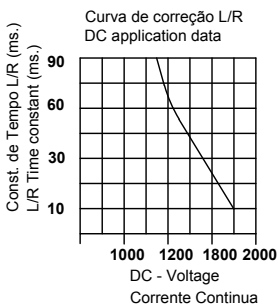
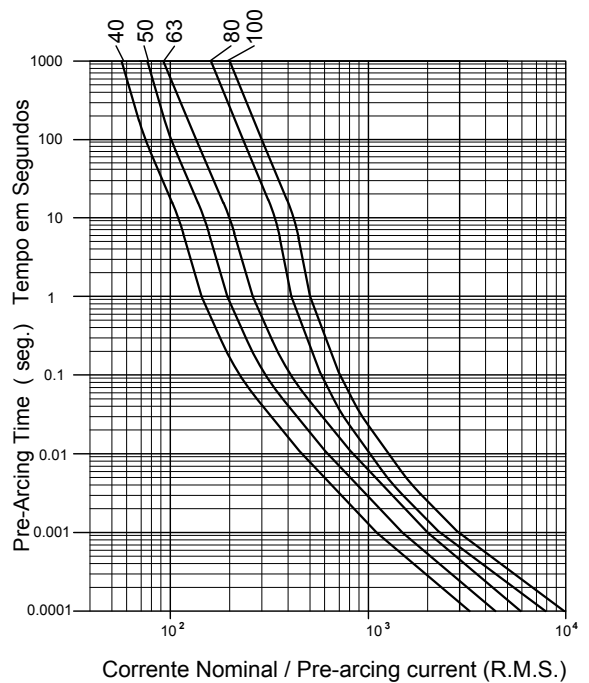

Fusível Cartucho para Corrente Contínua

DC Ferrul Fuses

gR 1500V DC



Cap.de Ruptura / Breaking capacity = 100 KA

- alta cap. de ruptura / high breaking capacity
- baixa perda / low power dissipation
- limitador de corrente / high current limiting

Dimensões / Dimensions

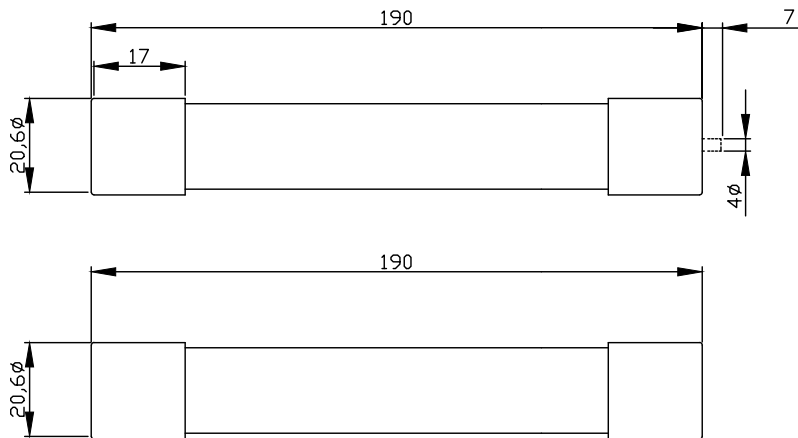

Características Elétricas / Electrical Characteristics

Nr. Ref.	Corrente Current	L / R	Perda Watts	Max. I ² t (A ² s.) Max. I ² t (A ² s.)
5411	6	60 ms.	4.8 W	28
5412	8	60 ms.	5.5 W	72
5413	10	60 ms.	6.5 W	180
5414	12	60 ms.	7.0 W	300
5415	16	60 ms.	8.0 W	580
5416	20	60 ms.	8.0 W	1.000
5417	25	60 ms.	8.0 W	1.500
5418	32	60 ms.	8.0 W	1.800

Curva Tempo - Corrente / Melting Time Curve

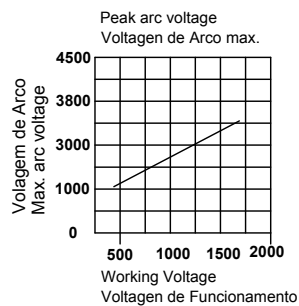
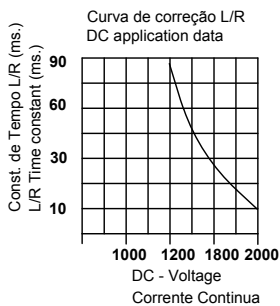
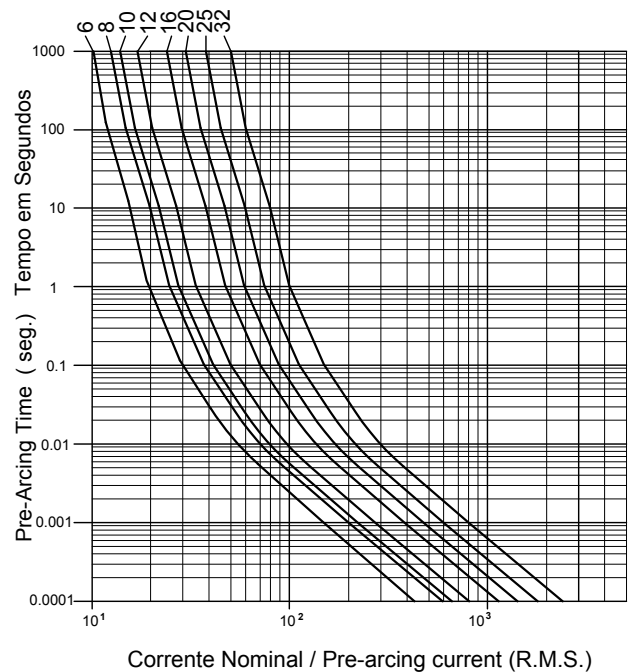

Fusível para Corrente Contínua DC Square-body Fuses gR 2000V DC

Cap.de Ruptura / Breaking capacity = 100 KA



Dimensões / Dimensions

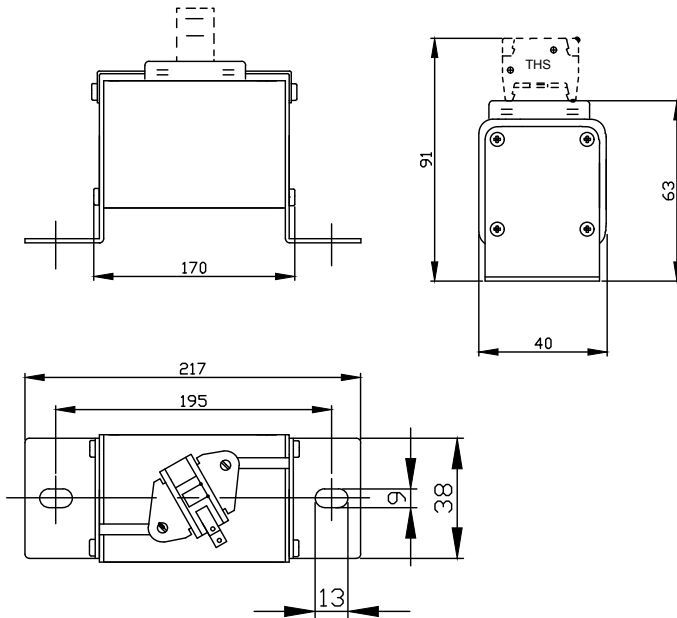

Curva Tempo - Corrente / Melting Time Curve

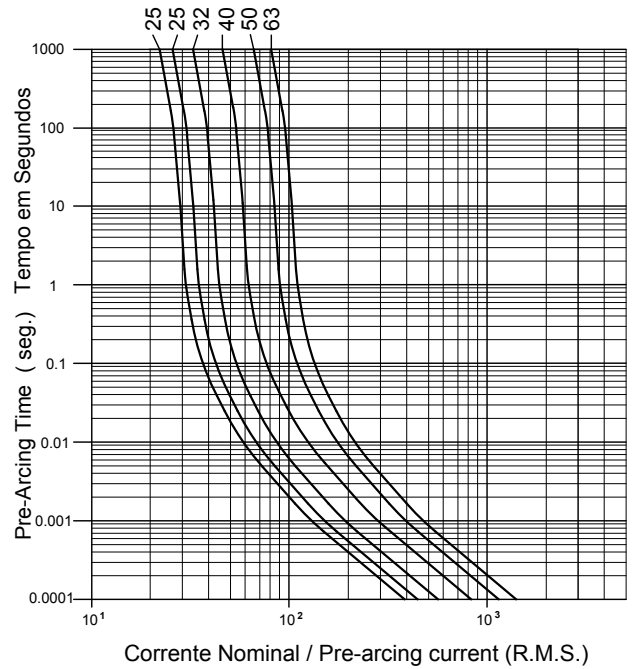

Características Elétricas / Electrical Characteristics

Nr. Ref.	Corrente Current	Tam. Size	L / R	Perda Watts	Max. I ² t (A ² s.)	Max. I ² t (A ² s.)
5464	20	1	15 ms.	8 W	180	
5465	25	1	15 ms.	12 W	250	
5466	32	1	15 ms.	14 W	355	
5467	40	1	15 ms.	17 W	580	
5468	50	1	15 ms.	20 W	1030	
5469	63	1	15 ms.	26 W	1600	
5470	80	1	15 ms.	30 W	3100	
5471	100	1	15 ms.	35 W	5800	
5472	125	1	15 ms.	43 W	9250	
5473	160	1	15 ms.	49 W	19200	
5474	200	1	15 ms.	51 W	45000	
5475	215	1	15 ms.	53 W	55000	

Curva Tempo - Corrente / Melting Time Curve

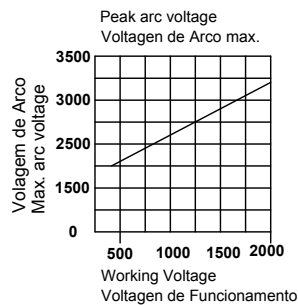
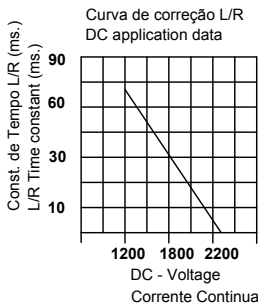
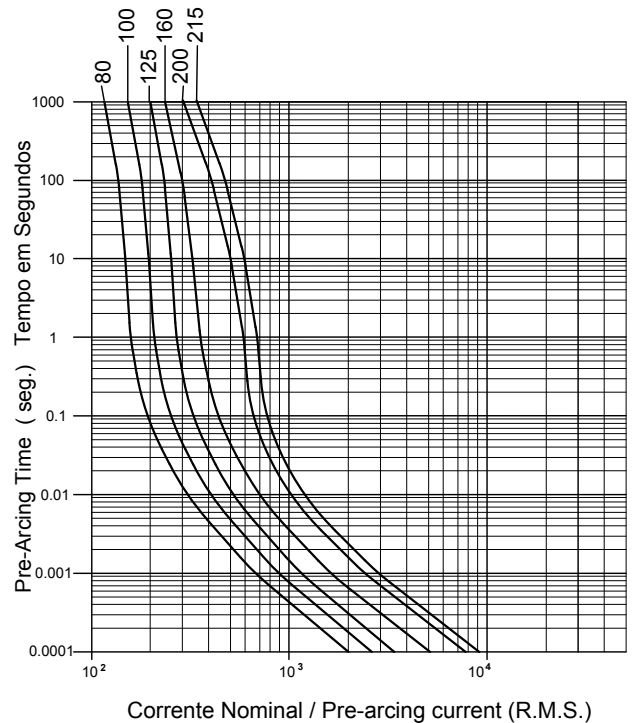

Fusível para Corrente Contínua

DC Square-body Fuses

gR 2000V DC

Cap.de Ruptura / Breaking capacity = 100 KA



Dimensões / Dimensions

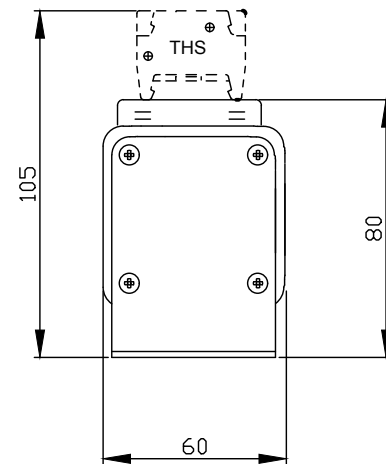
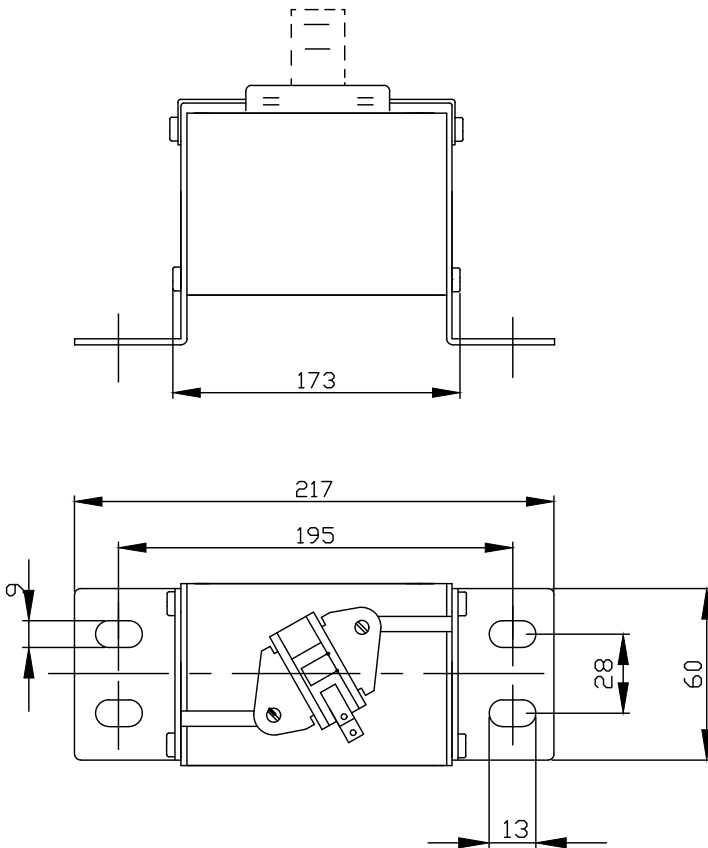

- alta cap. de ruptura / high breaking capacity
- baixa perda / low power dissipation
- limitador de corrente / high current limiting

Características Elétricas / Electrical Characteristics

Nr. Ref.	Corrente Current	Tam. Size	L / R	Perda Watts	Max. I ² t (A ² s.) Max. I ² t (A ² s.)
5476	160	2	30 ms.	52 W	15.000
5477	200	2	30 ms.	60 W	21.000
5478	250	2	30 ms.	68 W	45.000
5479	315	2	30 ms.	74 W	110.000
5480	400	2	30 ms.	88 W	212.000

Curva Tempo - Corrente / Melting Time Curve

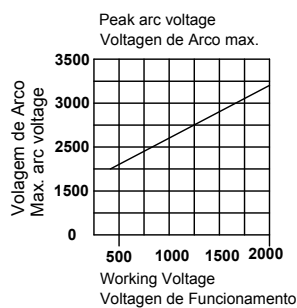
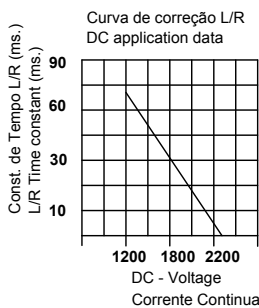
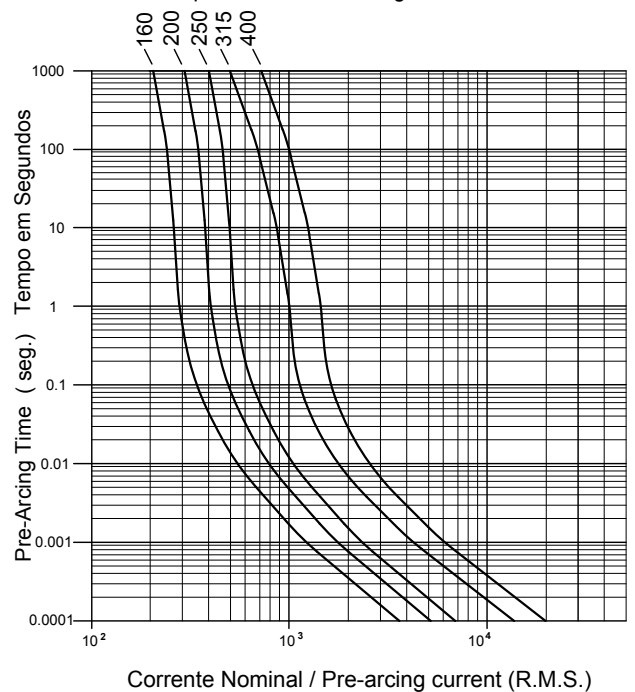

Fusível para Corrente Contínua

DC Square-body Fuses

gR 2000V DC



Cap.de Ruptura / Breaking capacity = 100 KA

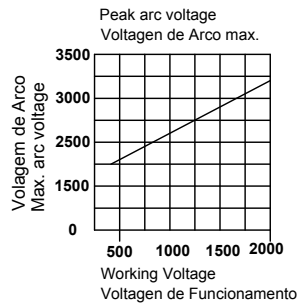
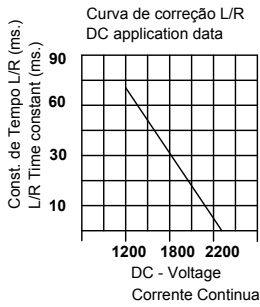

Curva Tempo - Corrente / Melting Time Curve

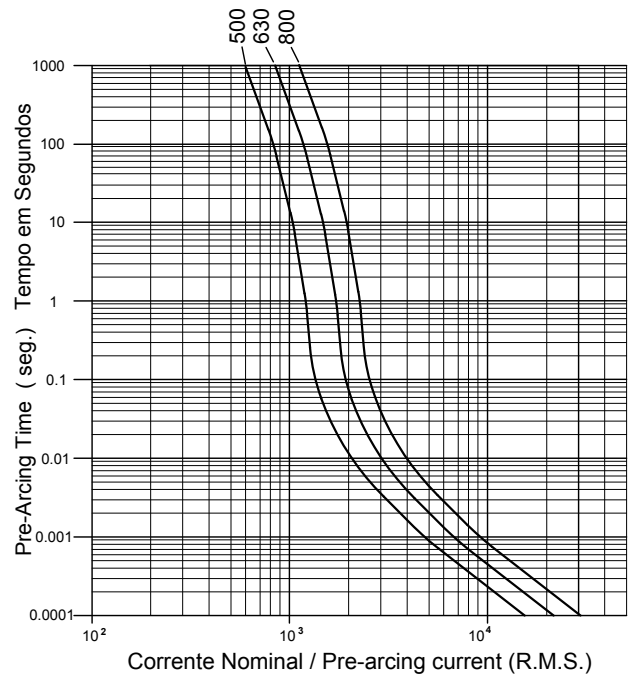

Características Eletricas / Electrical Characteristics

Nr. Ref.	Corrente Current	Tam. Size	L / R	Perda Watts	Max. I ² t (A ² s.) Max. I ² t (A ² s.)
5481	500	2x2	30 ms.	140 W	195.000
5482	630	2x2	30 ms.	155 W	460.000
5483	800	2x2	30 ms.	180 W	828.000

Dimensões / Dimensions

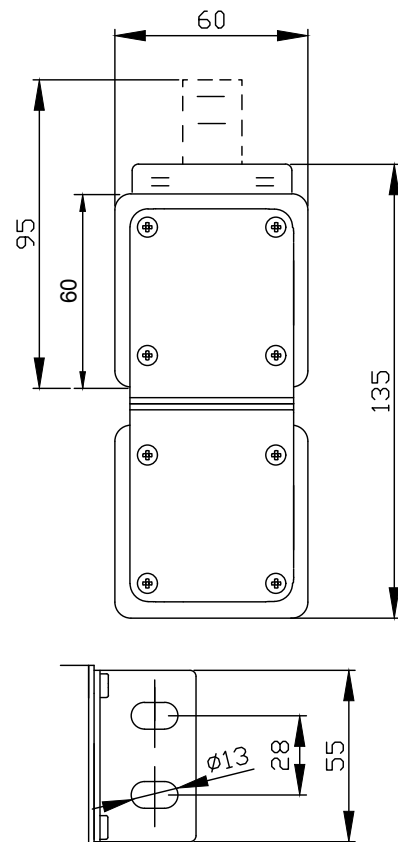
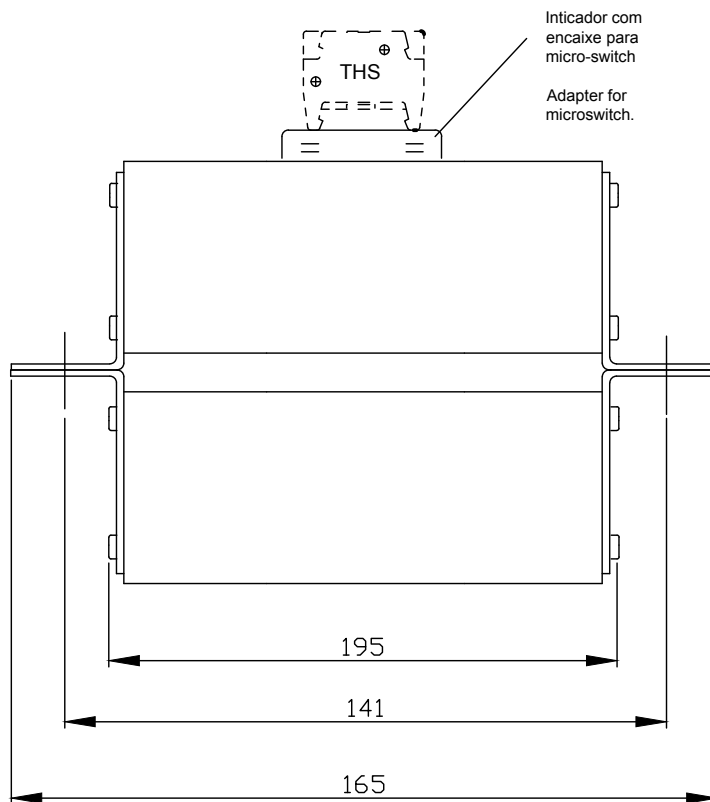

Fusível para Corrente Contínua DC Square-body Fuses gR 2000V DC



Cap.de Ruptura / Breaking capacity = 30 KA

Dimensões / Dimensions

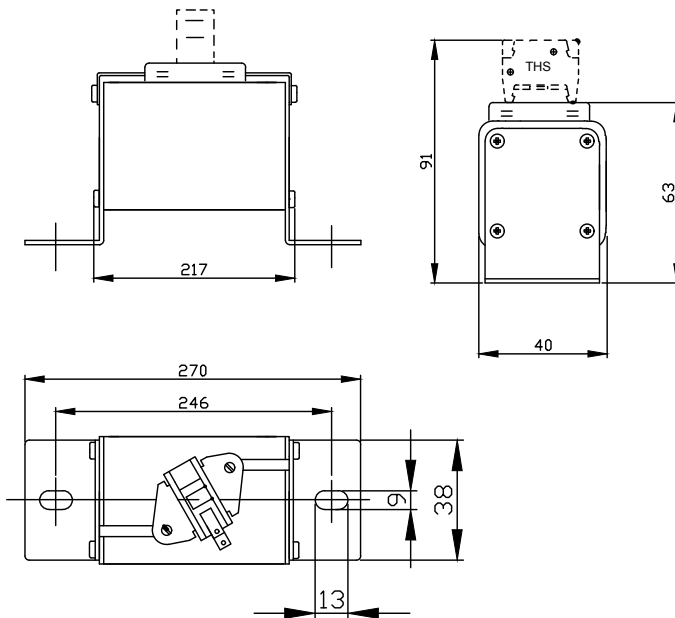

Curva Tempo - Corrente / Melting Time Curve

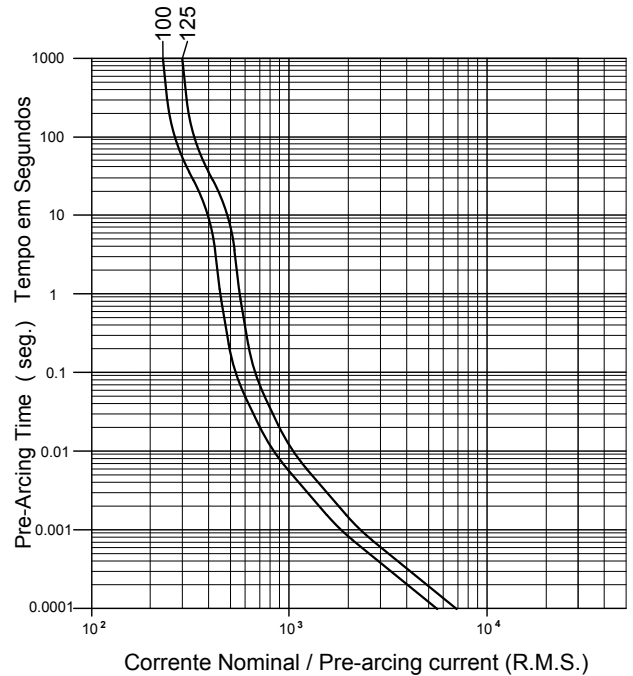

Características Elétricas / Electrical Characteristics

Nr. Ref.	Corrente Current	Tam. Size	L / R	Perda Watts	Cap. de Rup. Break. Cap.
5484	6	1	30 ms.	3 W	30 KA
5485	8	1	30 ms.	4 W	30 KA
5486	10	1	30 ms.	5 W	30 KA
5487	12	1	30 ms.	6 W	30 KA
5488	16	1	30 ms.	7 W	30 KA
5489	20	1	30 ms.	8 W	30 KA
5490	25	1	30 ms.	10 W	30 KA
5491	32	1	30 ms.	13 W	30 KA
5492	40	1	30 ms.	16 W	30 KA
5493	50	1	30 ms.	19 W	30 KA
5494	63	1	30 ms.	23 W	30 KA
5495	80	1	30 ms.	25 W	30 KA
5496	100	1	15 ms.	28 W	30 KA
5497	125	1	15 ms.	30 W	30 KA

Curva Tempo - Corrente / Melting Time Curve

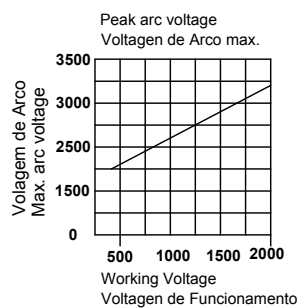
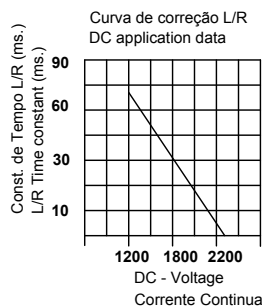
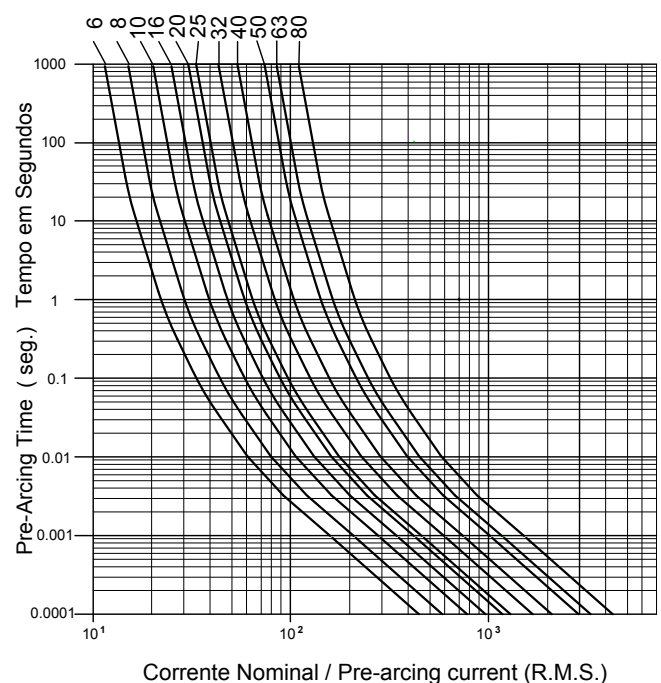

Fusível para Corrente Contínua

DC Square-body Fuses

gR 2000V DC



Dimensões / Dimensions

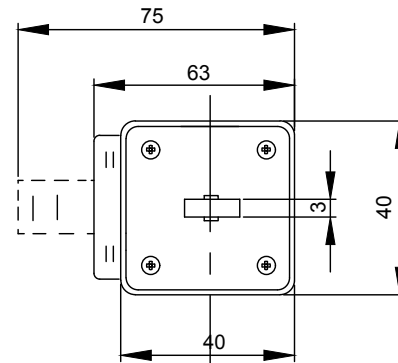
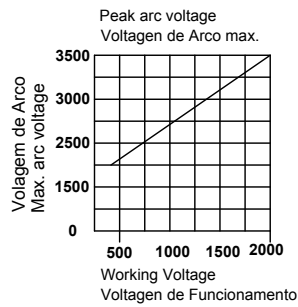
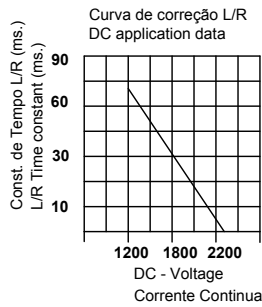

Características Elétricas / Electrical Characteristics

Nr. Ref.	Corrente Current	Tam. Size	L / R	Perda Watts	Cap. de Rup. Break. Cap.
5498	10	1	30 ms.	6 W	30 KA
5499	12	1	30 ms.	7 W	30 KA
5500	16	1	30 ms.	8 W	30 KA
5501	20	1	30 ms.	9 W	30 KA
5502	25	1	30 ms.	10 W	30 KA
5503	32	1	30 ms.	13 W	30 KA
5504	40	1	30 ms.	16 W	30 KA
5505	50	1	30 ms.	19 W	30 KA
5506	63	1	30 ms.	22 W	30 KA
5507	80	1	30 ms.	29 W	30 KA

Curva Tempo - Corrente / Melting Time Curve

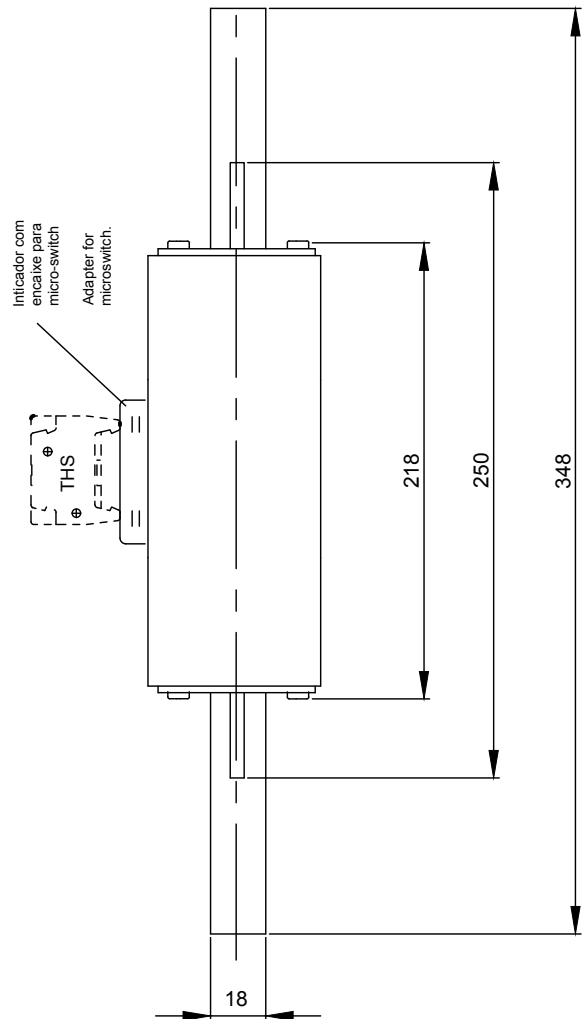
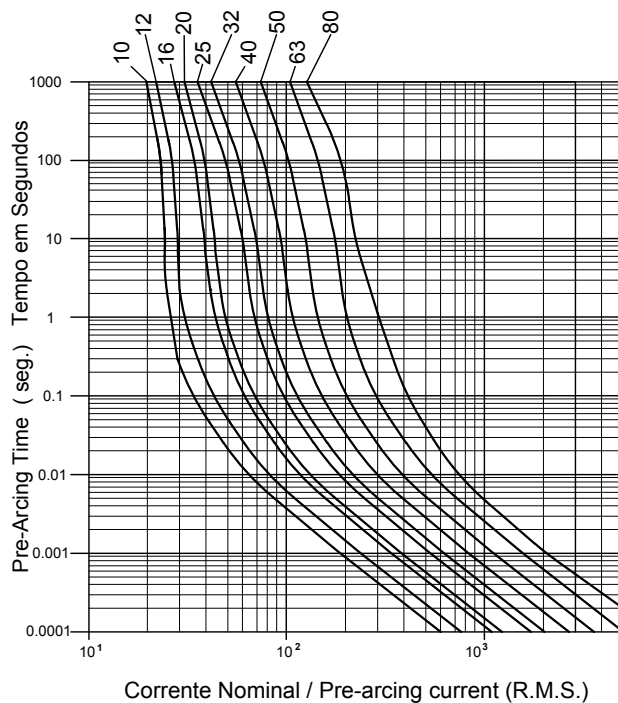

Fusível para Corrente Contínua

DC Square-body Fuses

gR 2000V DC



Dimensões / Dimensions

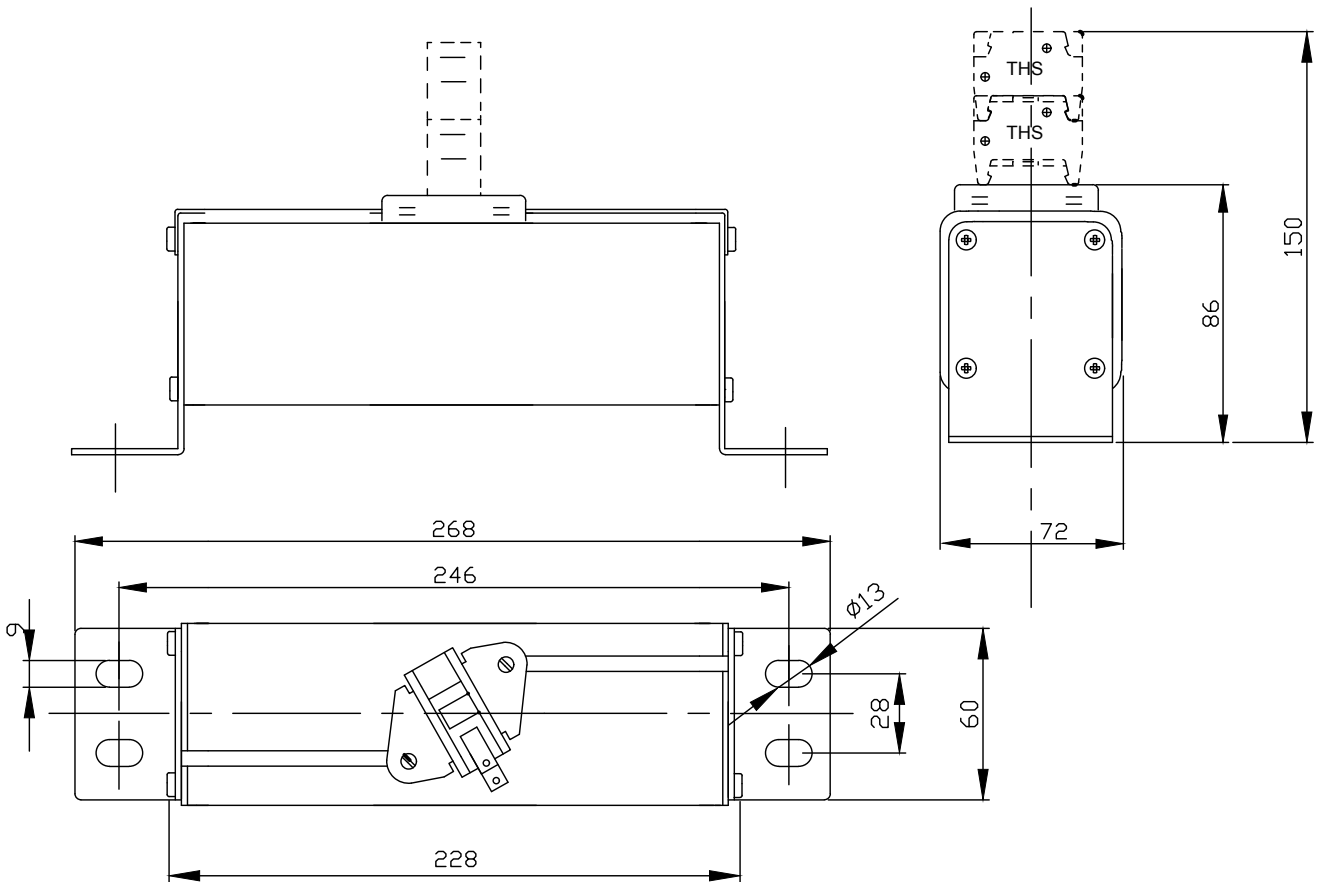

Características Elétricas / Electrical Characteristics

Nr. Ref.	Corrente Current	Tam. Size	L / R	Perda Watts	Cap. de Rup. Break. Cap.
5508	100	3	30 ms.	30 W	30 KA
5509	125	3	30 ms.	37 W	30 KA
5510	160	3	30 ms.	45 W	30 KA
5511	200	3	30 ms.	50 W	30 KA
5512	250	3	30 ms.	57 W	30 KA
5513	280	3	30 ms.	60 W	30 KA

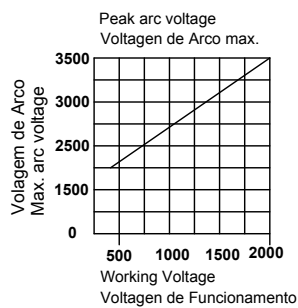
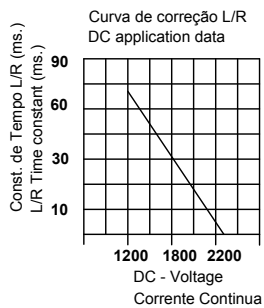

Curva Tempo - Corrente / Melting Time Curve

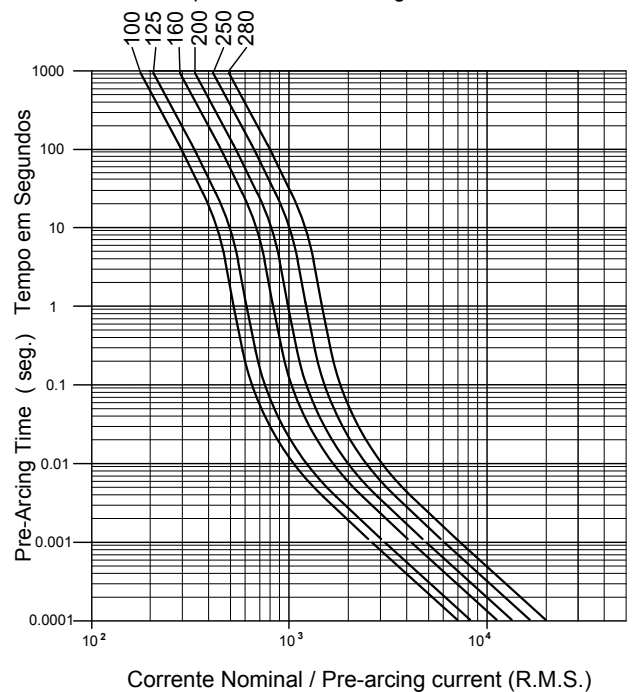

Fusível para Corrente Contínua

DC Square-body Fuses

gR 2000V DC



- alta cap. de ruptura / high breaking capacity
- baixa perda / low power dissipation
- limitador de corrente / high current limiting

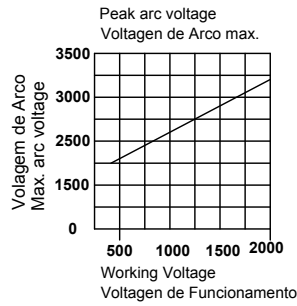
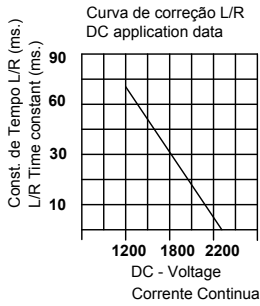

Curva Tempo - Corrente / Melting Time Curve

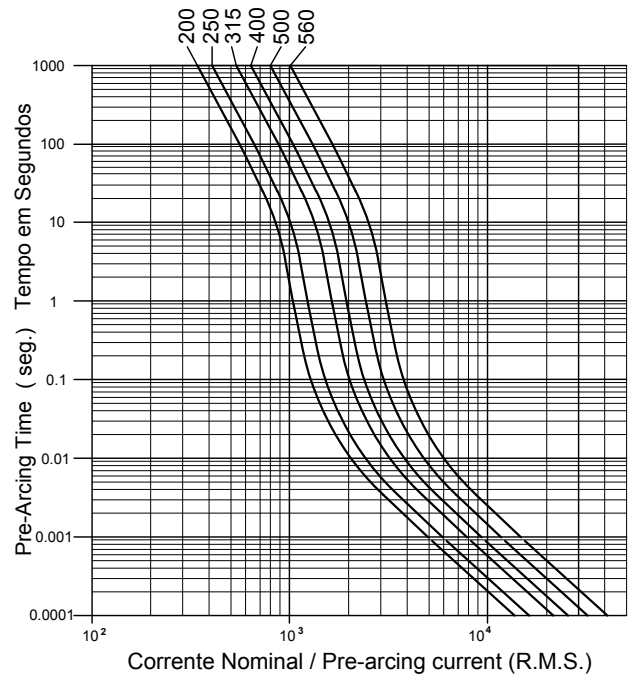

Características Elétricas / Electrical Characteristics

Nr. Ref.	Corrente Current	Tam. Size	L / R	Perda Watts	Cap. de Rup. Break. Cap.
5514	200	2x3	30 ms.	60 W	30 KA
5515	250	2x3	30 ms.	74 W	30 KA
5516	315	2x3	30 ms.	84 W	30 KA
5517	400	2x3	30 ms.	96 W	30 KA
5518	500	2x3	30 ms.	112 W	30 KA
5519	560	2x3	30 ms.	119 W	30 KA

Dimensões / Dimensions

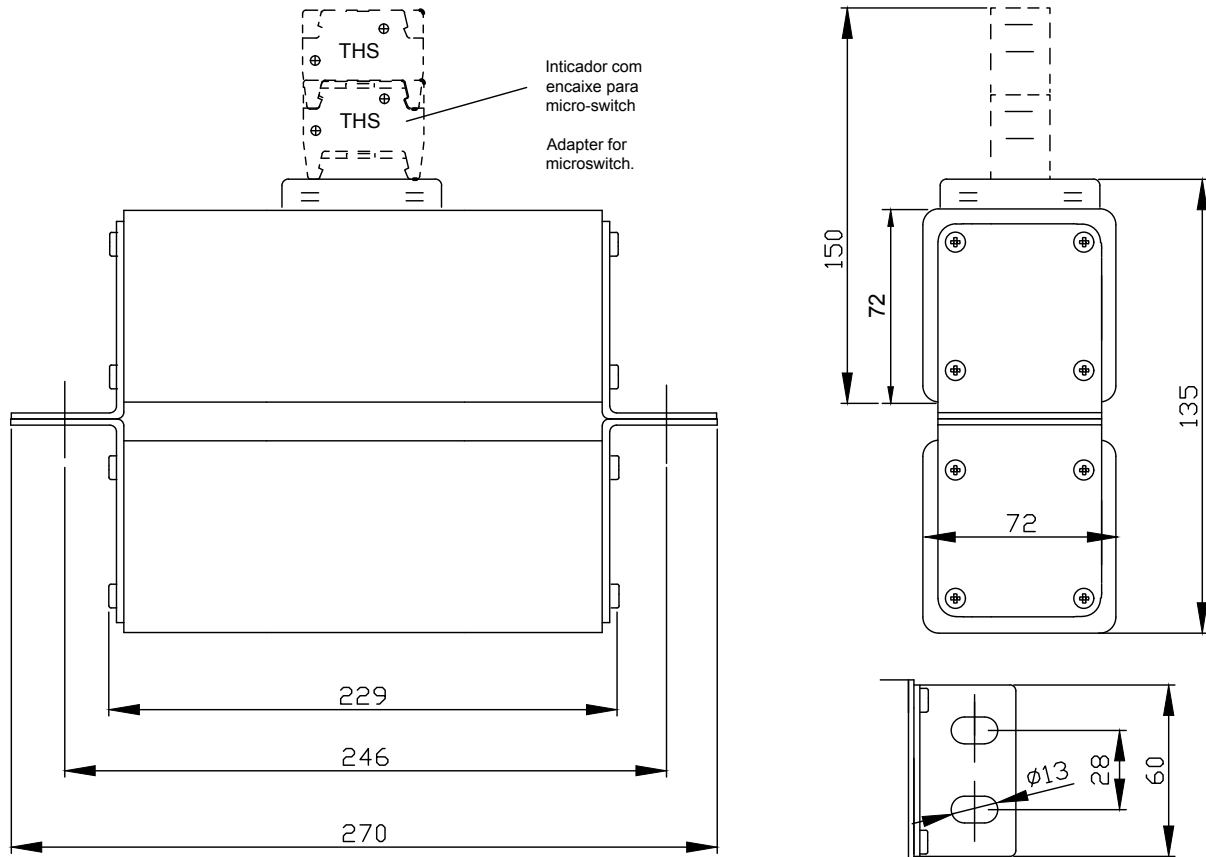

Fusível para Corrente Contínua

DC Square-body Fuses

gR 2400V DC

Dimensões / Dimensions

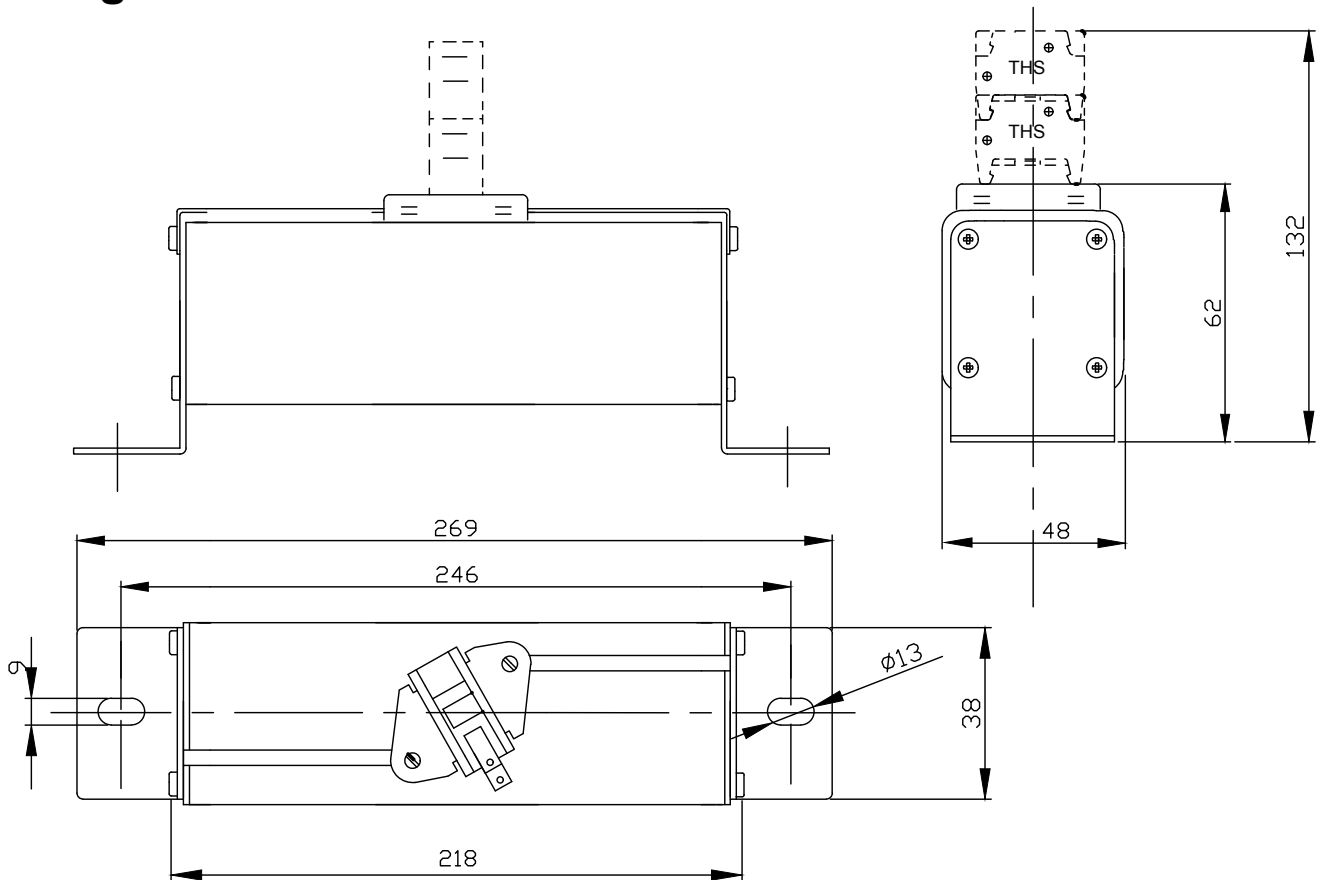

Características Elétricas / Electrical Characteristics

Nr. Ref.	Corrente Current	Tam. Size	L / R	Perda Watts	Cap. de Rup. Break. Cap.
5520	20	1	15 ms.	18 W	100 KA
5521	25	1	15 ms.	21 W	100 KA
5522	32	1	15 ms.	22 W	100 KA
5523	40	1	15 ms.	25 W	100 KA
5524	50	1	15 ms.	30 W	100 KA
5525	63	1	15 ms.	36 W	100 KA
5526	80	1	15 ms.	38 W	100 KA
5527	100	1	15 ms.	41 W	100 KA
5528	125	1	15 ms.	46 W	100 KA
5529	160	1	15 ms.	50 W	100 KA
5530	180	1	15 ms.	52 W	100 KA

Curva Tempo - Corrente / Melting Time Curve

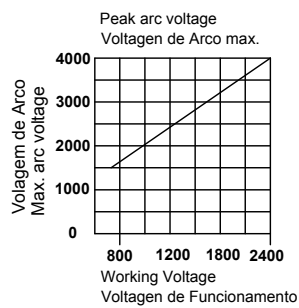
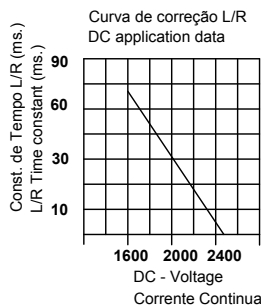
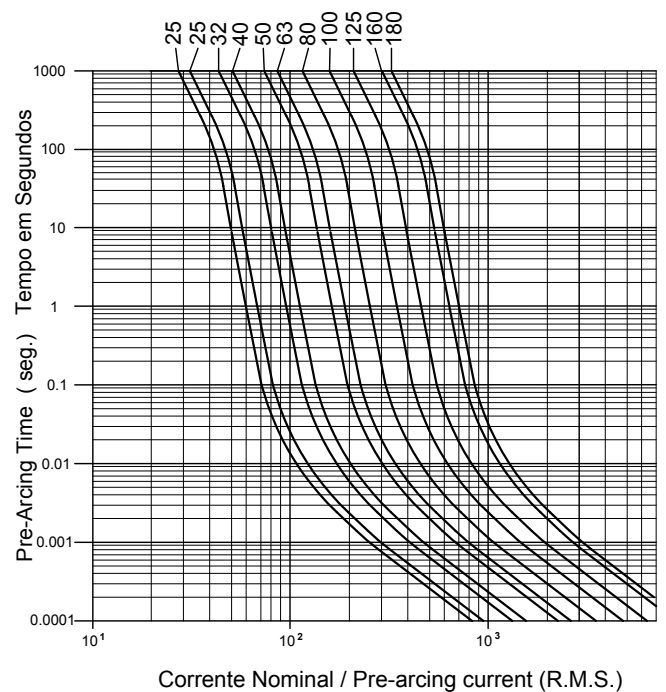

Fusível para Corrente Contínua

DC Square-body Fuses

gR 2400V DC

Dimensões / Dimensions

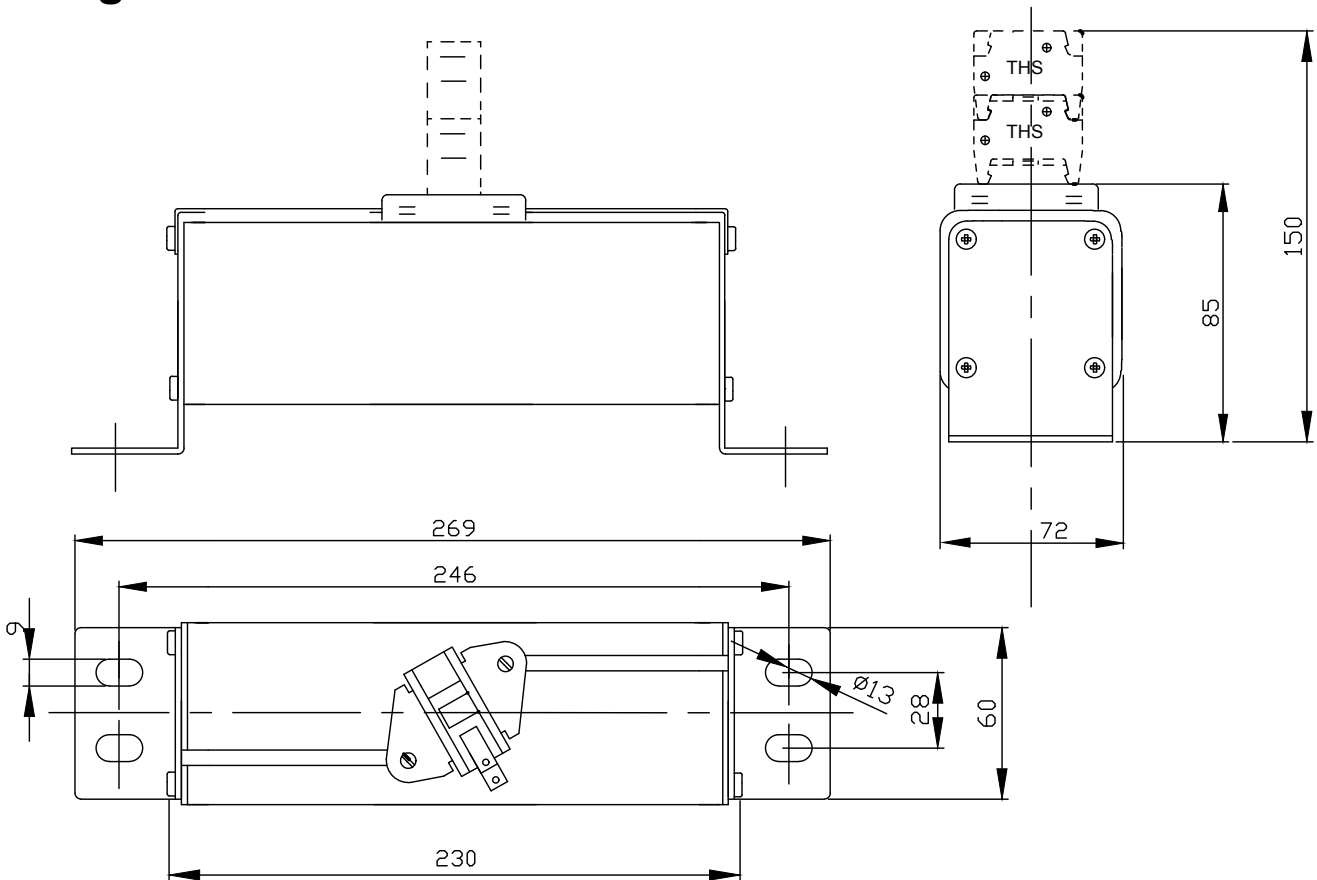

Características Elétricas / Electrical Characteristics

Nr. Ref.	Corrente Current	Tam. Size	L / R	Perda Watts	Cap. de Rup. Break. Cap.
5531	160	3	15 ms.	70 W	100 KA
5532	200	3	15 ms.	75 W	100 KA
5533	250	3	15 ms.	90 W	100 KA
5534	315	3	15 ms.	95 W	100 KA
5535	350	3	15 ms.	96 W	100 KA
5536	400	3	15 ms.	96 W	100 KA

Curva Tempo - Corrente / Melting Time Curve

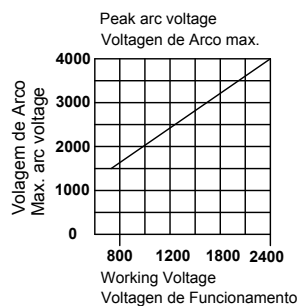
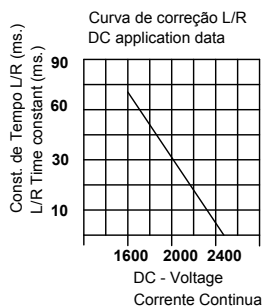
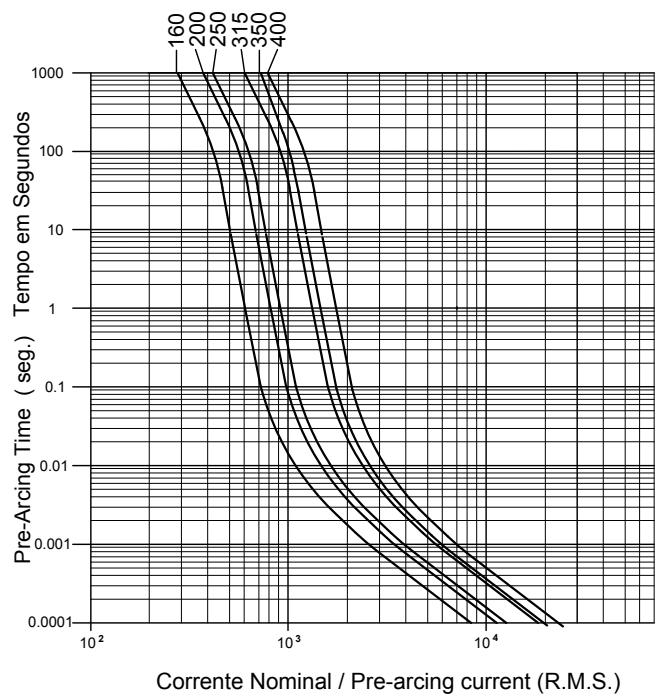

Fusível para Corrente Contínua

DC Square-body Fuses

gR 2400V DC



- alta cap. de ruptura / high breaking capacity
- baixa perda / low power dissipation
- limitador de corrente / high current limiting

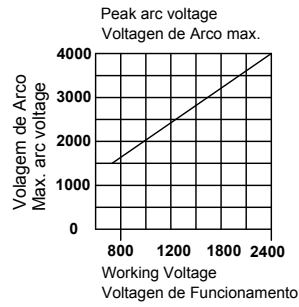
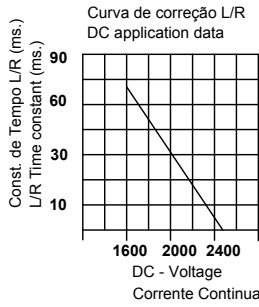

Curva Tempo - Corrente / Melting Time Curve

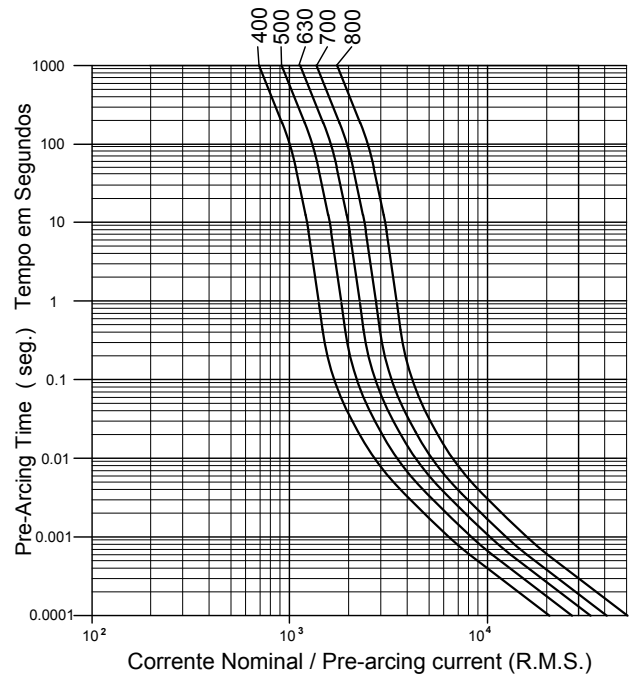

Características Elétricas / Electrical Characteristics

Nr. Ref.	Corrente Current	Tam. Size	L / R	Perda Watts	Cap. de Rup. Break. Cap.
5537	400	2x2	15 ms.	158 W	30 KA
5538	500	2x2	15 ms.	185 W	30 KA
5539	630	2x2	15 ms.	195 W	30 KA
5540	700	2x2	15 ms.	198 W	30 KA
5541	800	2x2	15 ms.	208 W	30 KA

Dimensões / Dimensions

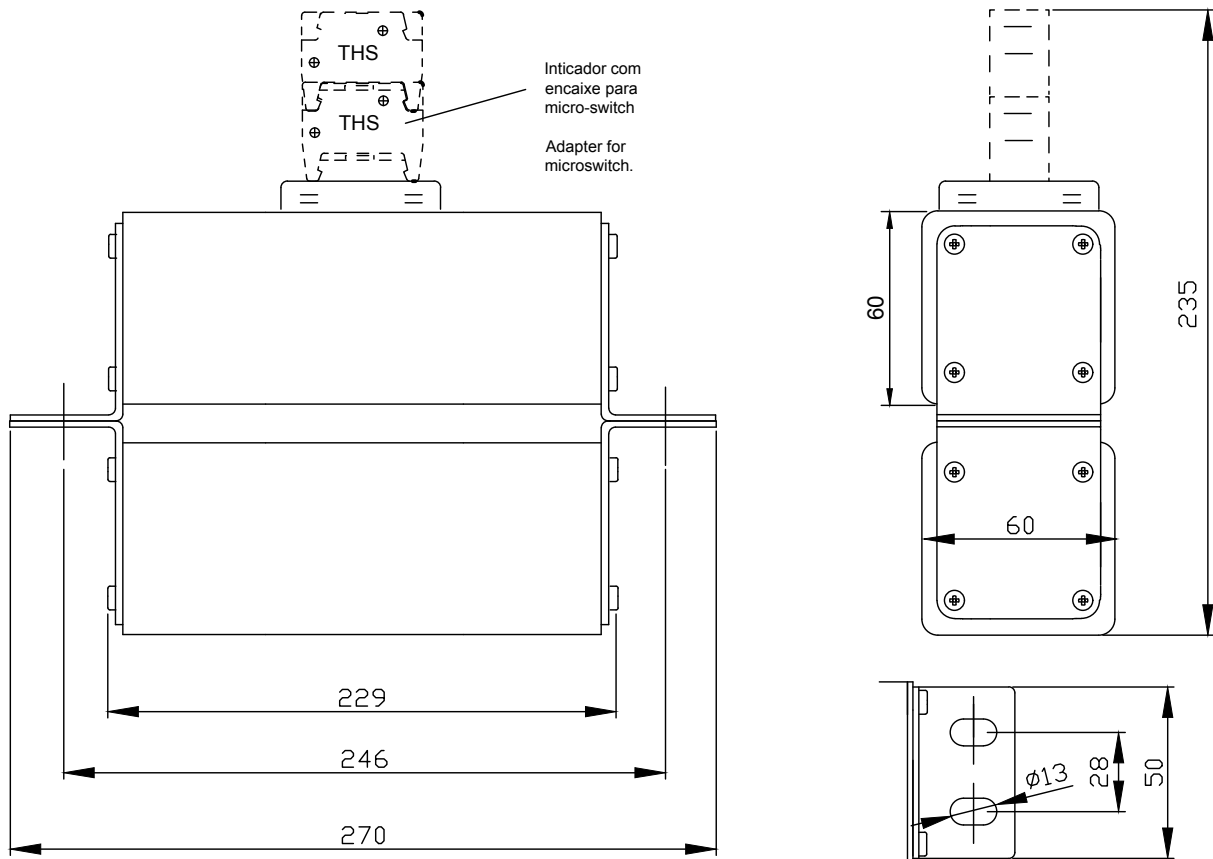

Fusível para Corrente Contínua

DC Round Body Fuse

gR 4000V DC



Dimensões / Dimensions

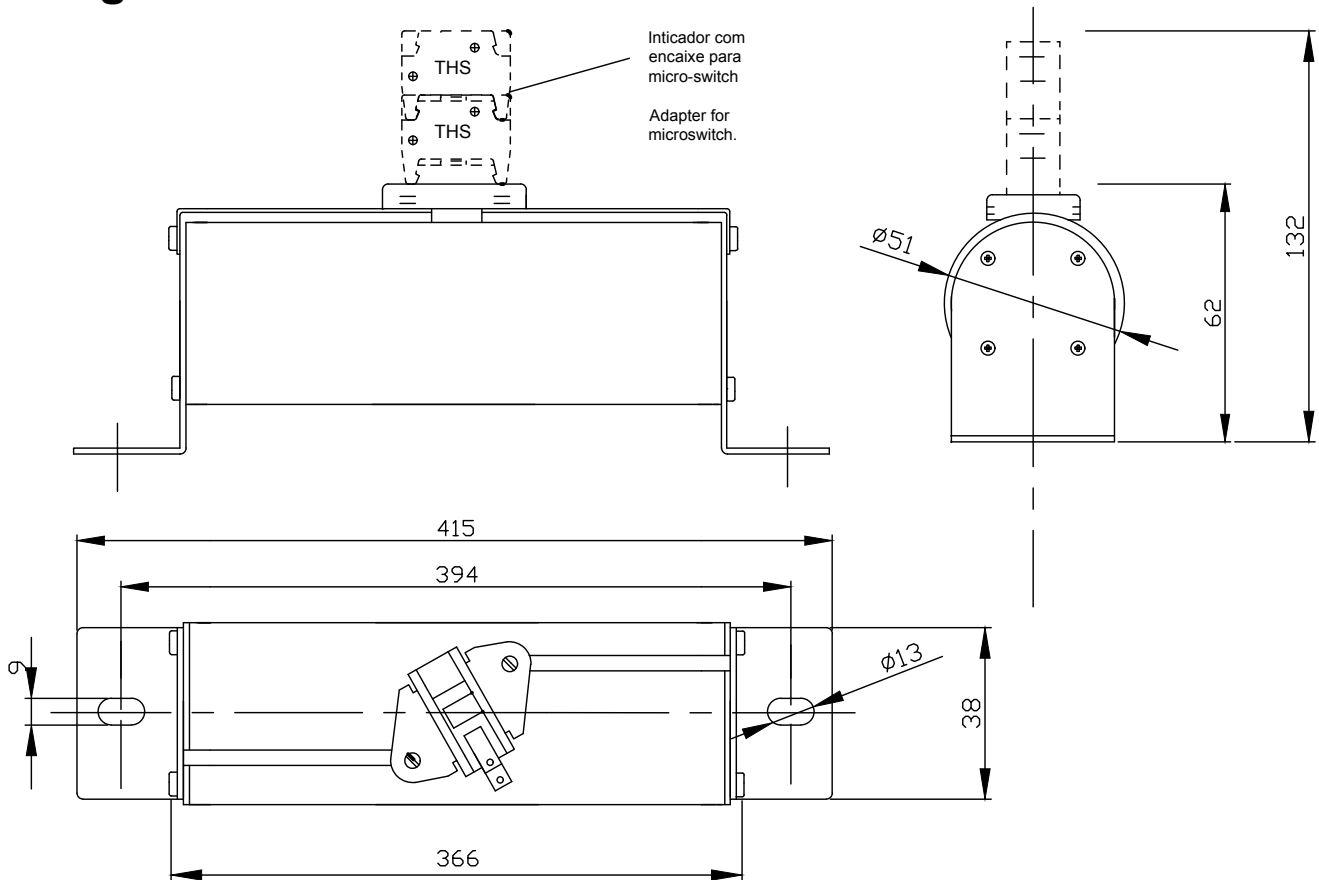

Características Elétricas / Electrical Characteristics

Nr. Ref.	Corrente Current	Tam. Size	L / R	Perda Watts	Cap. de Rup. Break. Cap.
5542	6/8/10	1	30 ms.	10 W	30 KA
5543	16	1	30 ms.	12 W	30 KA
5544	20	1	30 ms.	14 W	30 KA
5545	25	1	30 ms.	18 W	30 KA
5546	32	1	30 ms.	22 W	30 KA
5547	40	1	30 ms.	33 W	30 KA
5548	50	1	30 ms.	38 W	30 KA
5549	63	1	30 ms.	42 W	30 KA
5550	80	1	30 ms.	49 W	30 KA
5551	100	1	30 ms.	55 W	30 KA
5552	125	1	30 ms.	61 W	30 KA

Curva Tempo - Corrente / Melting Time Curve

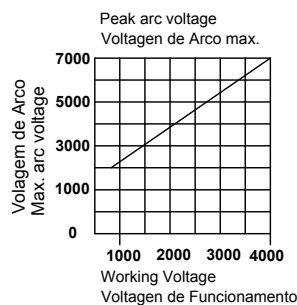
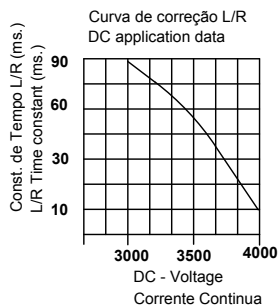
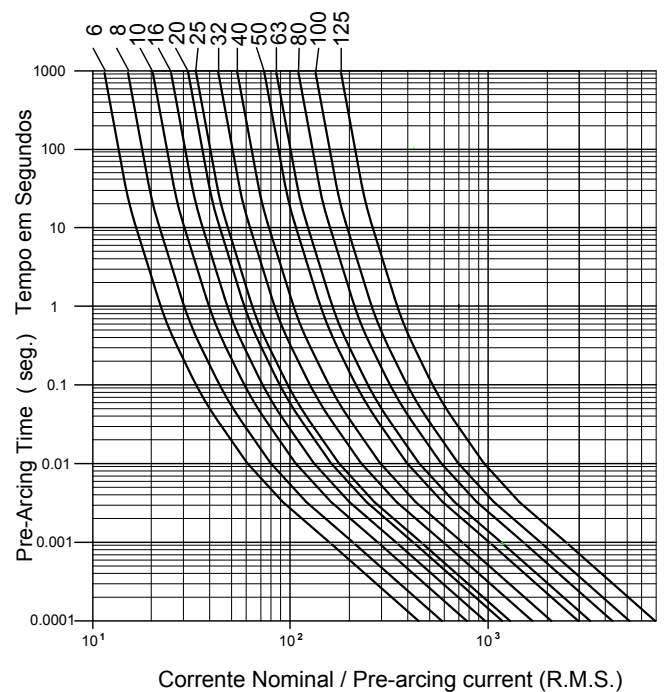

Fusível para Corrente Contínua

DC Round Body Fuse

gR 4000V DC



Dimensões / Dimensions

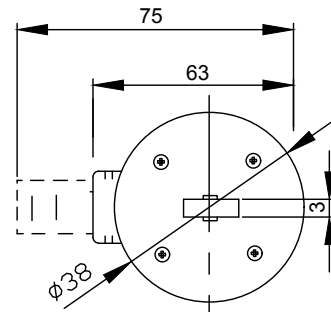
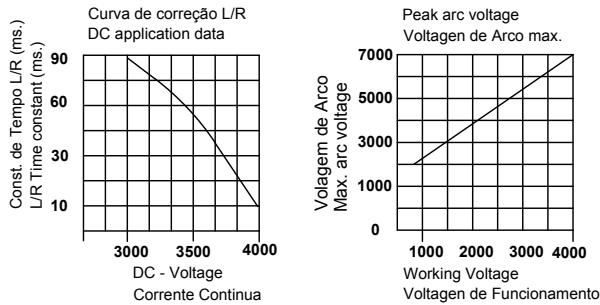

Características Elétricas / Electrical Characteristics

Nr. Ref.	Corrente Current	Tam. Size	L / R	Perda Watts	Cap. de Rup. Break. Cap.
5553	10	1	30 ms.	10 W	30 KA
5554	12	1	30 ms.	11 W	30 KA
5555	16	1	30 ms.	13 W	30 KA
5556	20	1	30 ms.	14 W	30 KA
5557	25	1	30 ms.	17 W	30 KA
5558	32	1	30 ms.	22 W	30 KA
5559	40	1	30 ms.	32 W	30 KA
5560	50	1	30 ms.	38 W	30 KA
5561	63	1	30 ms.	41 W	30 KA
5562	80	1	30 ms.	48 W	30 KA

Curva Tempo - Corrente / Melting Time Curve

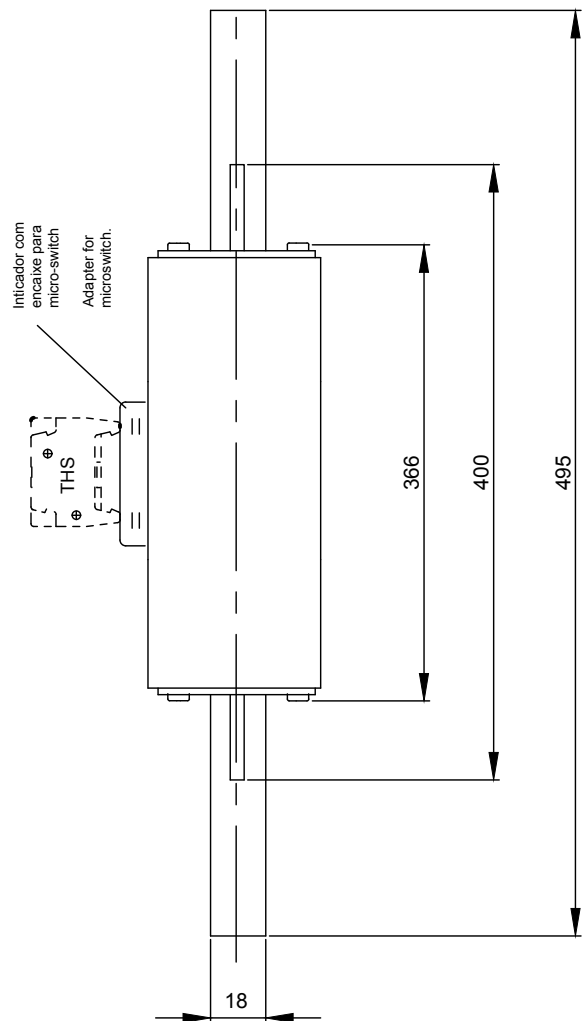
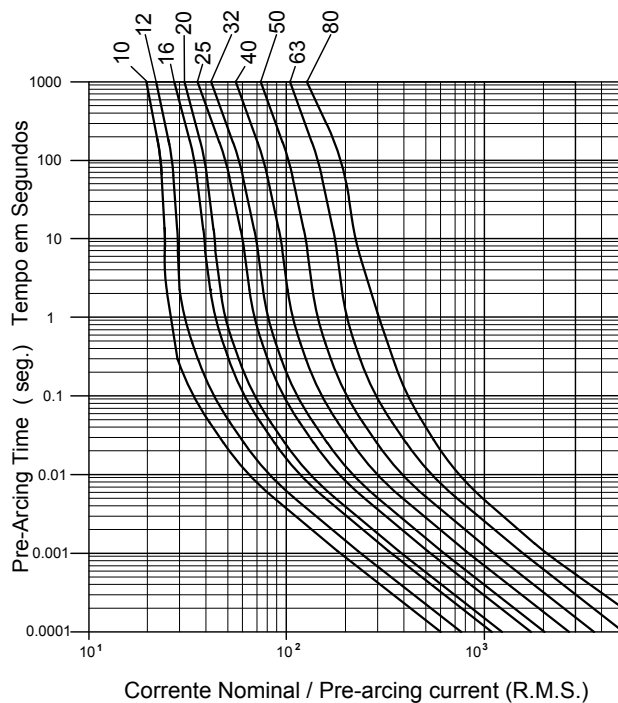

Fusível para Corrente Contínua

DC Round Body Fuse

gR 4000V DC



Dimensões / Dimensions

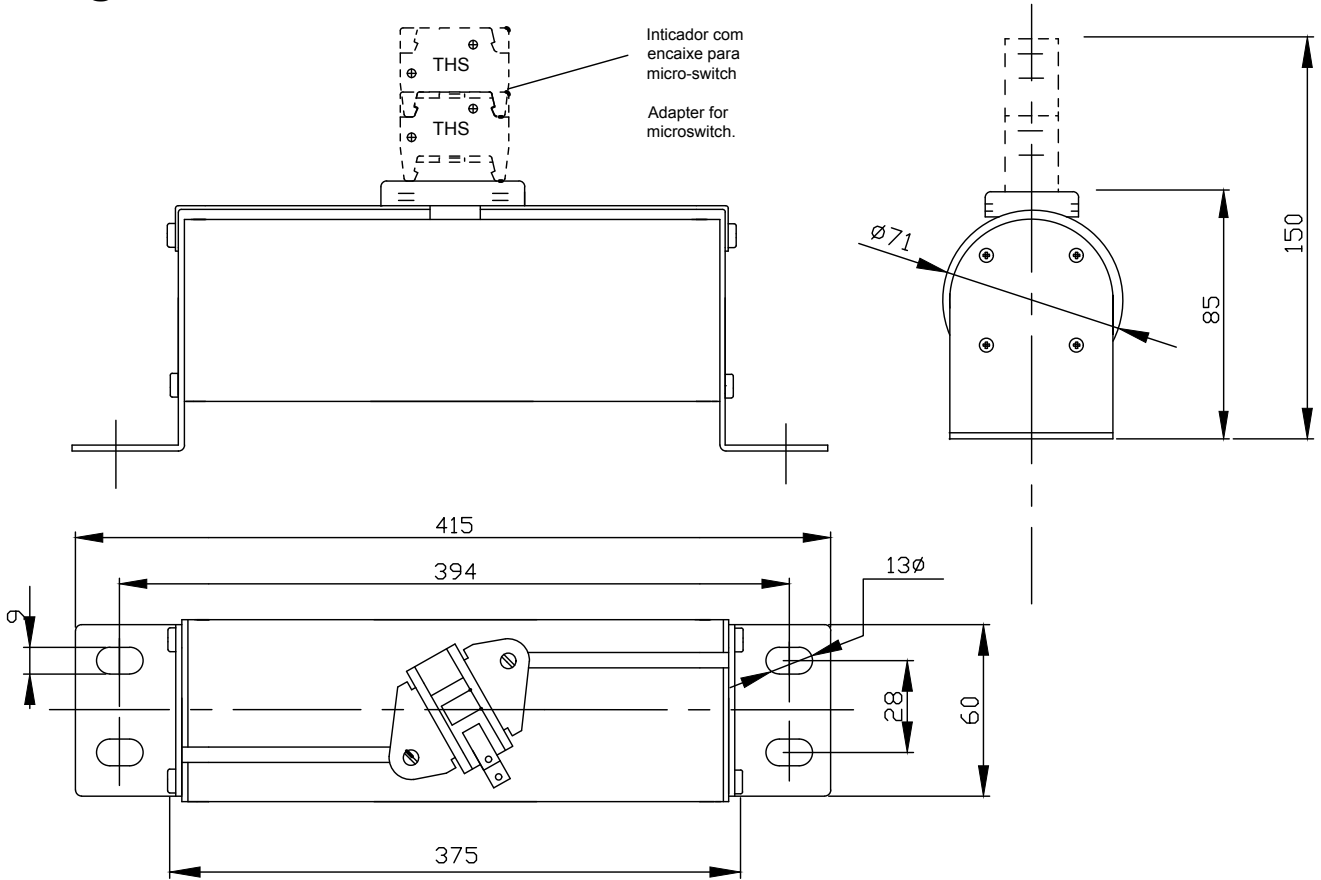

Características Elétricas / Electrical Characteristics

Nr. Ref.	Corrente Current	Tam. Size	L / R	Perda Watts	Cap. de Rup. Break. Cap.
5563	100	3	30 ms.	55 W	30 KA
5564	125	3	30 ms.	70 W	30 KA
5565	160	3	30 ms.	83 W	30 KA
5566	200	3	30 ms.	88 W	30 KA
5567	250	3	30 ms.	75 W	30 KA
5568	280	3	30 ms.	94 W	30 KA

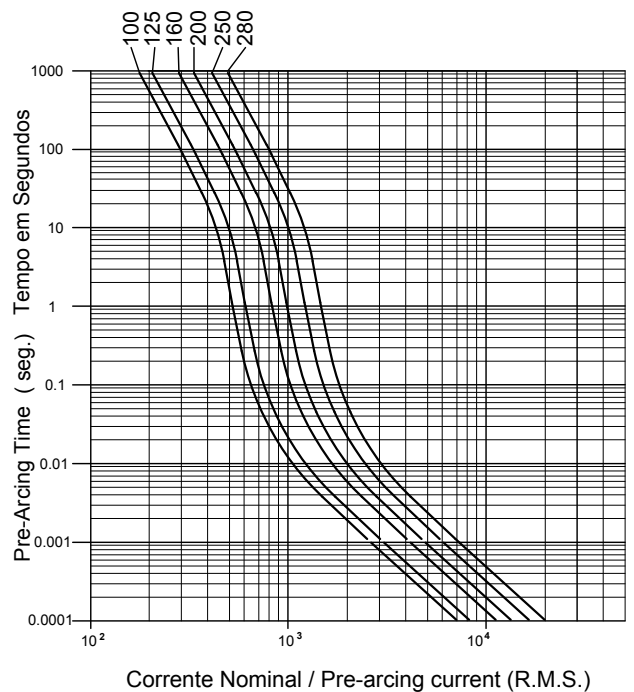
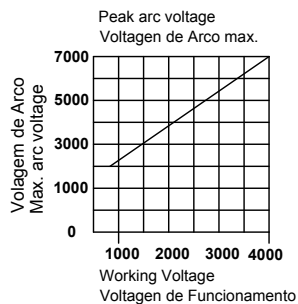
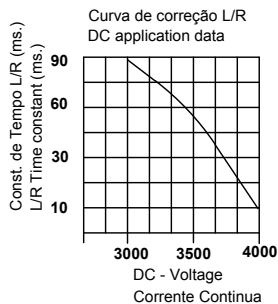

Fusível para Corrente Contínua

DC Round Body Fuse

gR 4000V DC



- alta cap. de ruptura / high breaking capacity
- baixa perda / low power dissipation
- limitador de corrente / high current limiting

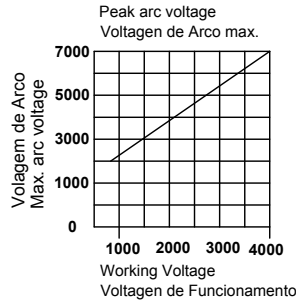
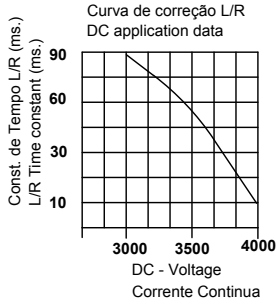

Curva Tempo - Corrente / Melting Time Curve

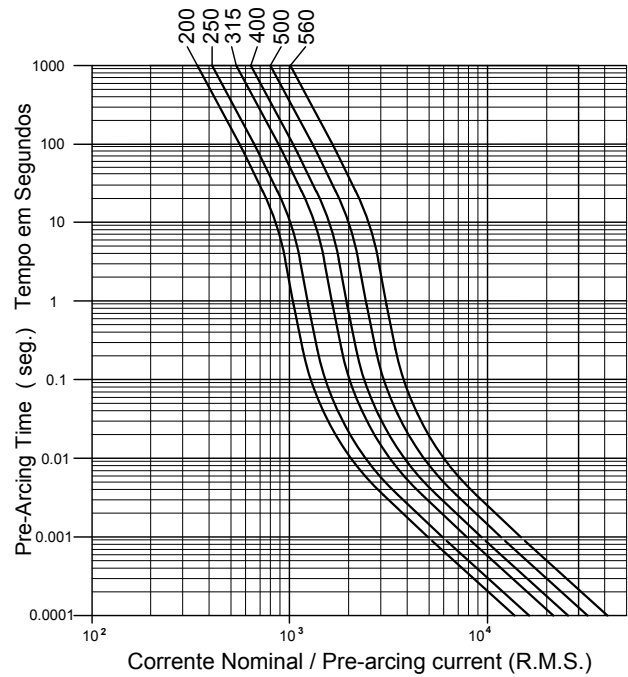

Características Elétricas / Electrical Characteristics

Nr. Ref.	Corrente Current	Tam. Size	L / R	Perda Watts	Cap. de Rup. Break. Cap.
5569	200	2x3	30 ms.	105 W	30 KA
5570	250	2x3	30 ms.	135 W	30 KA
5571	315	2x3	30 ms.	145 W	30 KA
5572	400	2x3	30 ms.	153 W	30 KA
5573	500	2x3	30 ms.	188 W	30 KA
5574	560	2x3	30 ms.	212 W	30 KA

Dimensões / Dimensions

